



a205/2 Rowe Dr, Potts Hill, NSW 2143

Leased - \$750 per Week

Apartment 3  2  2 



## MODERN 3 BEDROOM APARTMENT

A modern spacious apartment conveniently located in a modern building offering intercom security & elevators. This apartment provides a spacious living room attached to a large terrace balcony with a leafy outlook. The living is also open with the kitchen featuring gas cooktop, electric oven and dishwasher. There are three (3) good sized bedrooms with mirrored built-in wardrobes. The master bedroom features an en-suite and a spacious balcony capturing a cool breeze. Has a modern bathroom and an internal laundry. The apartment is fully air conditioned and features gas heating connections, it is located on the second floor in a secured building. Has a secured tandem car space inside the basement garage and has a storage cage. Contact Gerard on 0402 118 415 or 9644 3999.

### Open for Inspection

By Appointment.

### Property Features

- STYLISH & BREEZY MODERN APARTMENT.
- THREE (3) BEDROOMS, BALCONY & EN-SUITE.
- LIVING WITH BIG BALCONY OPEN TO KITCHEN.
- DUCTED AIR CONDITIONING & GAS HEATING.
- TANDEM CAR SPACE & STORAGE CAGE.
- LOCATED IN A TRANQUIL & SERENE REAR CORNER.

### Listed By

Gerard Allport  
Phone: (02) 96443999  
Mobile: 0412282885



## Floorplan

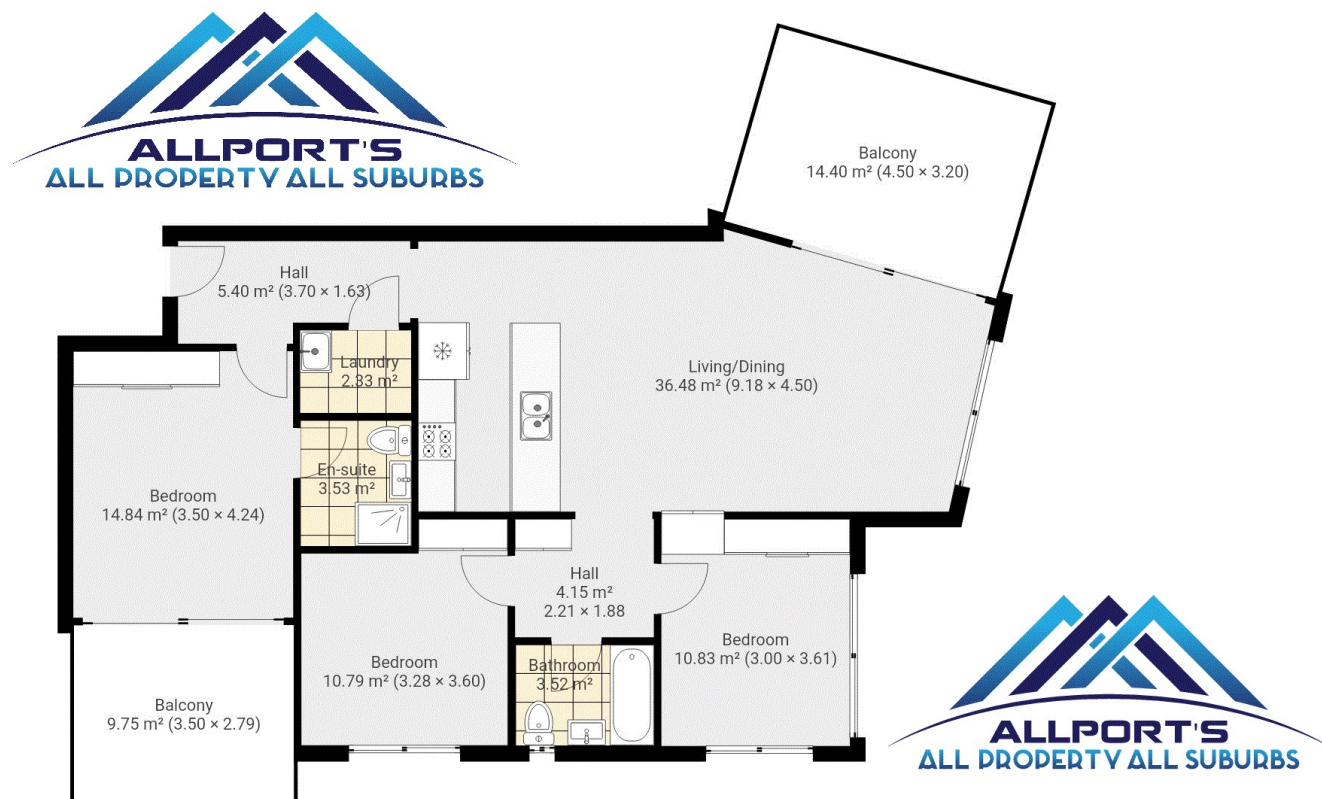

THIS FLOORPLAN IS PROVIDED WITHOUT WARRANTY OF ANY KIND. SENSOPIA DISCLAIMS ANY WARRANTY INCLUDING, WITHOUT LIMITATION, SATISFACTORY QUALITY OR ACCURACY OF DIMENSIONS.