

2205/167 Alfred St, Fortitude Valley, QLD 4006

Sold - 20/02/2024

Apartment 1  1 



SOLD BY ANA WANG

Brisbane's top bars, music venues, restaurants and recreational facilities are just a lift ride and a short walk away if you secure this swish, fully air-conditioned 22nd-floor one-bedroom apartment with a versatile floorplan that provides you with bonus space to comfortably run a home business or maybe pick up some handy extra rent!

Open for Inspection

By Appointment.

Highlights:

- One of a handful of properties in VH with a master suite + an enclosed study/MPR (or bed 2)
- A fully enclosed glass balcony means peaceful sleeps without compromising incredible views
- Walk to CBD, river, train & Howard Smith Wharves, cycle to West Village, ferry to Southbank
- Zoned for Brisbane State High, Fortitude Valley and Kelvin Grove State Colleges
- Unrivalled onsite amenities: rooftop pool and bar, full gym, cinema, spa, yoga retreat

From the carpets to the gleaming stone bench tops in the kitchen, the presentation of this light-filled apartment is excellent and, for a one-bedder in the city it punches well above its weight.

First up, the master-size bedroom offers more than most: plush carpet, extra height 2.5m ceilings, slider access onto a section of the glass-enclosed covered balcony, and a generous built-in robe.

Next door is a fully enclosed, carpeted multi-purpose room/study with a handy built-in desk. If you're studying, this room will be useful - giving you a space outside of your living and sleeping areas to set up the computer screens and spread out the books! If you're not, it makes a great area for running your side hustle or reconfigure to a second bedroom for yourself or to rent.

The hybrid floored kitchen looks over the combined living/dining area which extends through banked sliders onto the balcony. Fully enclosed and illuminated, you can use this private alfresco-style space, any time of the day or night and whatever the weather - blocking out the city sounds if you wish. We highly recommend it as a spot for savouring the views across the city to the river, Storey Bridge and beyond.

A clever kitchen design maximises the space available. Pull up a stool at the two-person dining bar or the four-seat dining table attached. On the cook's side of the dining bar is prep space, the sink, a dishwasher and storage. Behind is a big pantry, gas cooker with rangehood, oven and an integrated fridge. It's all crisp white.

Listed By

Peter Crowther

Phone: (07) 3344 0288

Mobile: 0411 866 008



Floorplan

POINTS OF INTEREST

1. VALLEY HOUSE
2. Howard Smith Wharves | 3. James Street Precinct
4. New Farm Park | 5. Brisbane Powerhouse
6. Kangaroo Point Cliffs & Esplanade
7. Southbank Parklands | 8. The Gabba
9. Gasworks Plaza | 10. Brisbane Showgrounds
11. Riverwalk | 12. Royal Brisbane & Women's Hospital
13. Queen's Wharf & Pedestrian Bridge
14. QUT Gardens Point Campus & Brisbane Riverstage

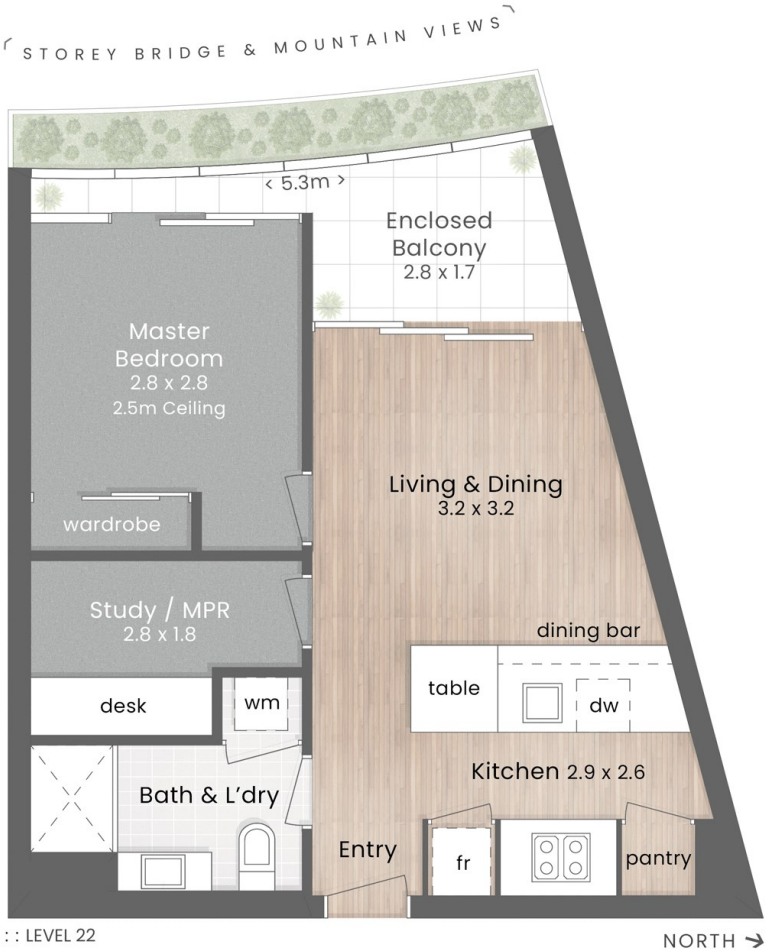

VALLEY HOUSE 2205/167 Alfred Street FORTITUDE VALLEY

1 Bed + MPR 1 Bath

Internal 44m² | Enclosed Balcony 6m² | Total 50m²

LJ Hooker
Property Partners

DISCLAIMER: This is not a legal document therefore all measurements and information provided is subject to survey. No permission is given to use or alter this Floor Plan without the consent of Pure Design Concepts. The overall presentation style, layout, imagery, fonts, background, colours and terminology has been originally created by PDC and is subject to strict copyright. No ownership is taken of building design. Find out more at puredesignconcepts.com.au

pdc.