



5/6-10 Hyde Park Rd, Berala, NSW 2141

\$590,000 - \$609,000

Apartment 2  2  1 



Ground Corner location – Ideal Home Office or Pro Suite

This warm & comfortable apartment is located in the heart of the Berala business district, providing all amenities surrounding your dream home. Only minutes walking distance to Berala Station and Shopping Centre including Woolworths Berala, Mannings Pharmacy and Discount Chemist Berala.

You could enjoy your morning breakfast at Rogue Café or Golden Lea Bakery nearby, dine in with global cuisine of your choice at Berala famous Asian Gourmet Noodle House, the Pure Thai Restaurant or J's Kitchen Steak House.

Your dream home occupies 2 spacious bedrooms with built-in wardrobe, the master bedroom has private ensuite and the guest bedroom has an open balcony. The modern kitchen equipped with cooking gas stove, a dishwasher and an electric oven combining with an extensive lounge and dining area. It also owns a secure underground parking. Nice family home for 2 adults and 2 kids.

Front ground level corner location an ideal potential home office or professional suite subject to approval.

Open for Inspection

By Appointment.

Listed By

John Luong
Phone: (02) 9633 9955

Adam Chang
Phone: (02) 9633 9955
Mobile: 0417 818 018



Floorplan

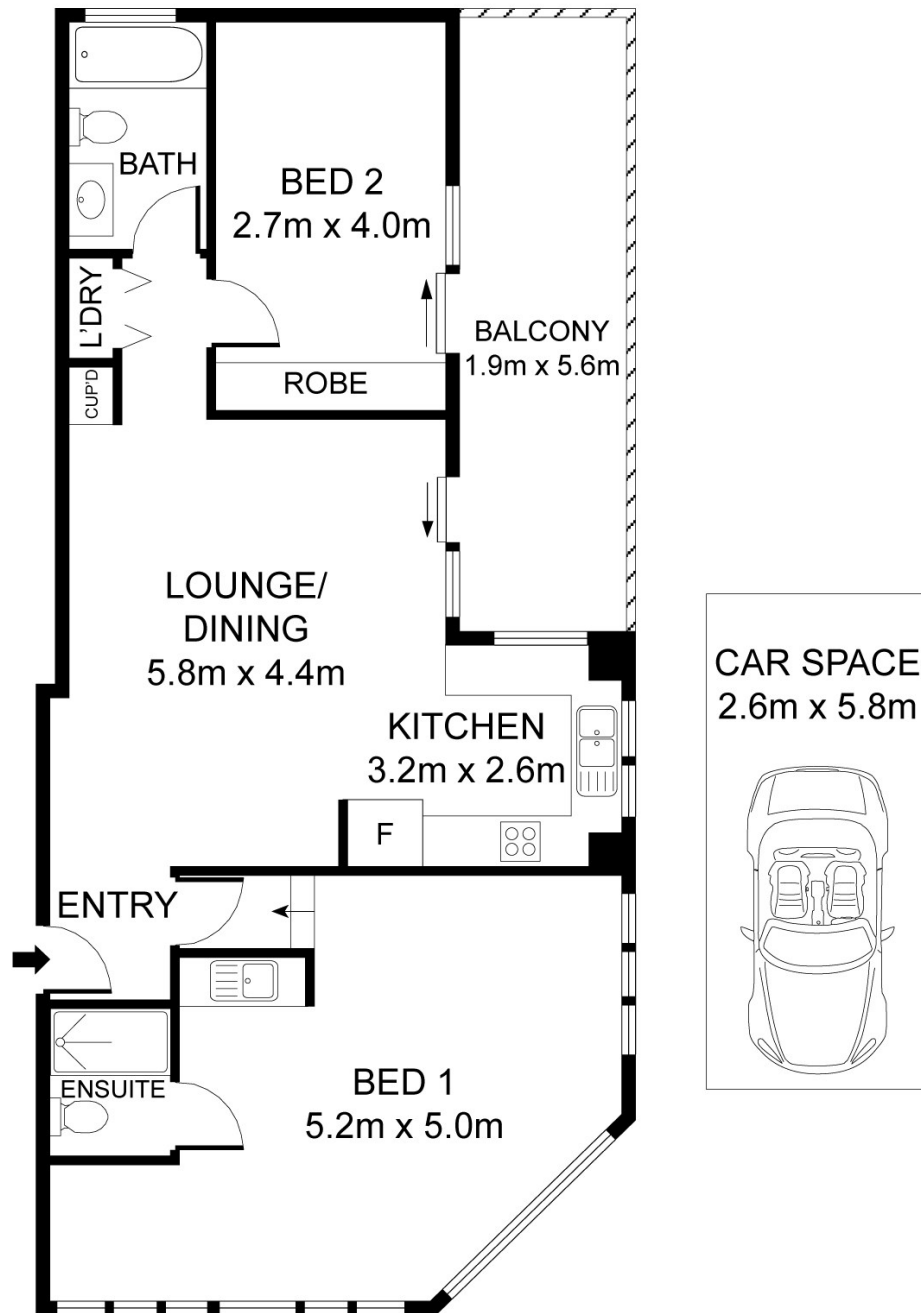

5/6-10 Hyde Park Road, Berala

INTERNAL AREA: 81 SQM APPROX.

DISCLAIMER: 3D Property View accepts no liability for the accuracy of details contained within our floor plans. All plans are drawn and also checked to the best of our ability, however information contained in our floor plans such as area calculations are approximate, and have not been surveyed or drawn to scale. Our floor plans are for representational purposes only and should be used as such. Do not attempt to refer to our floor plans for structural or detailed information.