

67 Fourth Ave, Raymond Island, VIC 3880

Sold - 4/09/2023

House 4 3 4



VIEWS, VIEWS, VIEWS!!!!

Boasting mesmerizing, far-reaching 180-degree views over the Gippsland Lakes to Paynesville, this contemporary home offers a relaxing coastal lifestyle and includes a jetty berth which is just meters away. Situated across the road from the lake in the heart of the township and just a short ferry ride to restaurants, cafes and shops.

Vaulted ceiling to entry, superb light filled open plan living spaces which include kitchen and expansive living and dining areas with glorious uninterrupted lake views through the impressive frameless glass windows. Also, direct access to the outdoor entertaining decks. Master bedroom with WIR and ensuite. Located at the other end of the home is a further three bedrooms, one with ensuite plus kitchenette and spacious bathroom. All bedrooms open to the view deck and enjoy similar lake views.

Take the stairs to the third living area with powder room, wet bar and seamless access to the tiled balcony.

9m x 6m shed with lean-to for extra storage, vehicle access to rear yard and beautiful manicured gardens complete this lovely package.

If you're looking for a change of lifestyle or perhaps a holiday home, somewhere you can spend family vacations boating, swimming and fishing or a place you can wake up and listen to the water lapping the shore, then look no further.

Open for Inspection

By Appointment.

Listed By

Lorraine Edlington
Phone: (03) 5156 6166
Mobile: 0437 532 860



Floorplan

67 Fourth Ave, Raymond Island

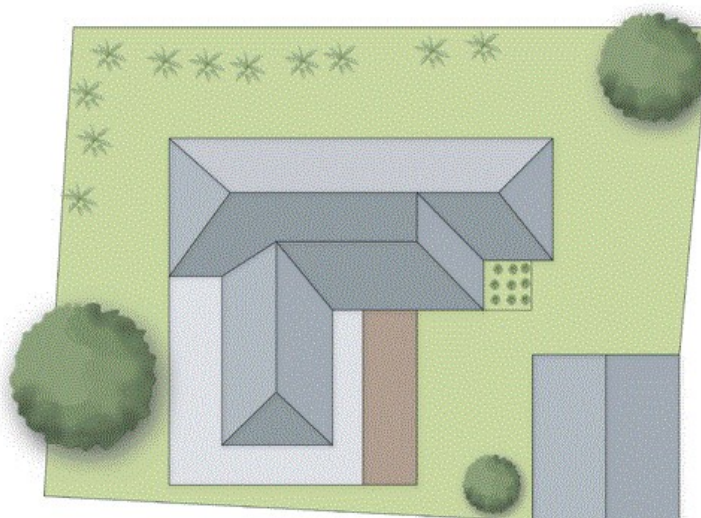

archistyle

Whilst every attempt has been made to ensure the accuracy of this floorplan, measurements of doors, windows, rooms and any other items are approximate only. The producer or the agent cannot be held responsible for any errors, omissions or misstatements. This plan is for illustrative purposes only and should be used as such.