

F306/26-56 Rothschild Ave, Rosebery, NSW 2018

Sold - \$535,000

Apartment 1   1 



One Bedroom Apartment in "OTTO"

Welcome to Otto, located in the heart of Rosebery.

Positioned on Level 3, apartment F306 is a one bedroom apartment featuring;

- Spacious living area opening to covered balcony
- Open plan kitchen with gas cooking and ample storage
- Good size bedroom with built-in wardrobe
- Modern bathroom
- Internal laundry
- Ducted zoned air-conditioning
- Video security intercom & lift access
- Storage cage

Conveniently located (approx.) 4.5 km to the Sydney CBD & 3.5 km to Sydney airport & 1.1 km walk to Green Square Train Station.

Close to popular local cafe's and eateries with Woolworths Metro across the road & City bound bus stops at the front door.

Open for Inspection

By Appointment.

Listed By

Guy Bezzina

Mobile: 0418 699 171



Floorplan

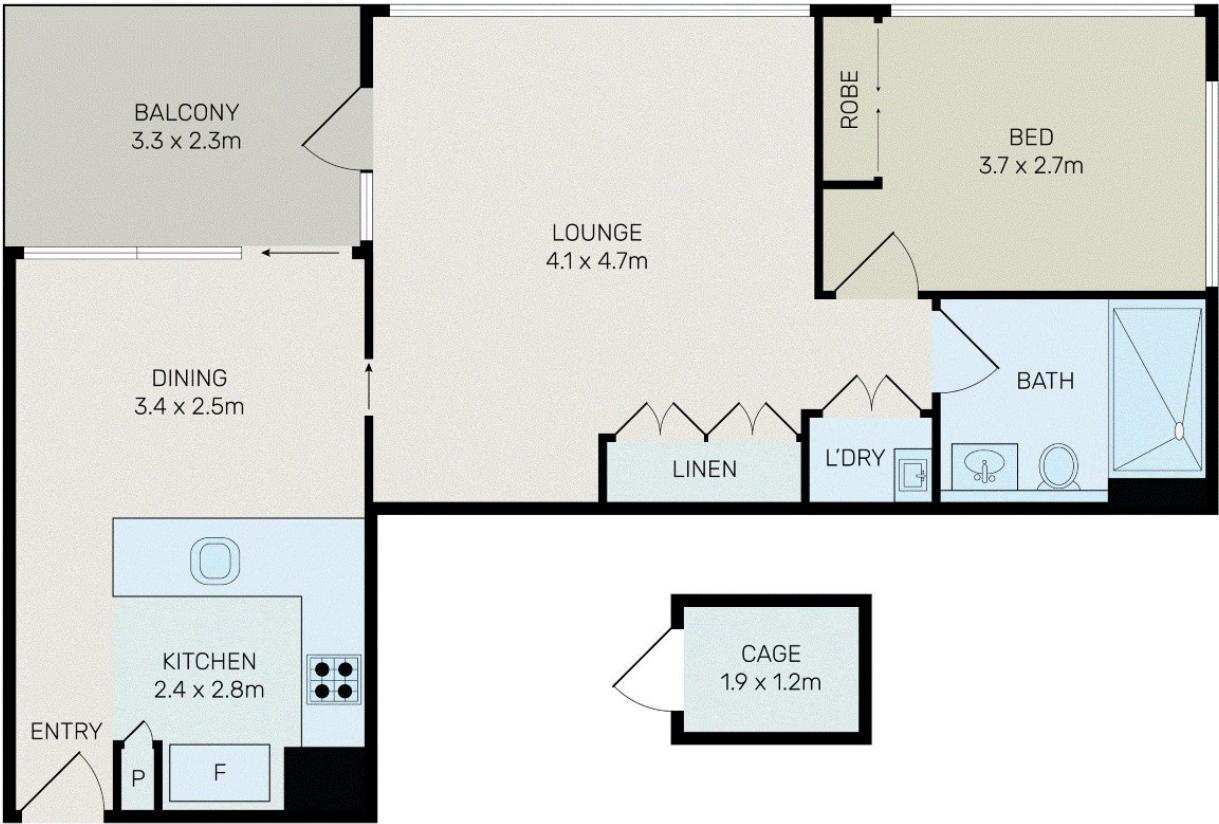

All information contained herein is gathered from all sources we believe to be reliable. However we cannot guarantee its accuracy and interested parties should rely on their own enquiries.



F306/26-56 Rothschild Avenue, Rosebery