



9/1 Henry Lawson Wk, East Perth, WA 6004

Sold - 15/08/2022

Apartment 3  2  2 



## Riverside Elegance...

Nestled in a secure, well-managed and expertly-maintained boutique complex of only 24 units at "The Gallery", this magnificent 3 bedroom 2 bathroom apartment oozing style and quality also boasts stunning views of the Claisebrook inlet, the beautiful Victoria Gardens and Crown Towers and is conveniently located within close proximity (and easy walking distance) of public transport and the free CAT bus route into the CBD, shopping, restaurants and the Royal Street cafe strip.

### Open for Inspection

By Appointment.

Positioned at the famous footbridge that crosses the Cove and perfectly aligned with everything you love about an inner-city locale, this elegant residence is light, bright, airy and warmed by polished Herringbone parquetty timber floors at its entry. The open-plan living and dining area is large and the bedrooms are all double-sized at the very least, with the well-appointed galley-style kitchen playing host to sparkling stone bench tops, ample storage, a modern dishwasher, gas cooktop, an under-bench oven and more.

The second bedroom - with private balcony access and a verdant vista - is almost of queen proportions, much like a sumptuous master suite that features built-in wardrobes, alongside a sleek, fully-tiled ensuite bathroom with a shower and twin "his and hers" vanities. The third bedroom enjoys the luxury of built-in robes, too. A semi-ensuite "main" bathroom off the second bedroom comes complete with a soaking bathtub that defines relaxation.

There is also a separate powder room, a separate laundry and an all-encompassing water outlook from the entertaining/sitting balcony, off the living room. Two secure car bays ensure that this one ticks absolutely all of your boxes. Ever dreamt of living right at the water's edge? Well you won't get much closer than this!

Features include:

- Single level 3 bedrooms, 2 bathrooms
- Spacious living and dining area
- Quality galley style kitchen
- River side balcony for entertaining
- Private master suite
- Second bathroom with a bathtub
- Separate laundry
- Powder room
- Ducted air conditioning

### Listed By

Brendan Smith  
Phone: (08) 9325 0700  
Mobile: 0420 217 818

Sharon Smith  
Phone: (08) 9325 0700  
Mobile: 0405 814 948



## Floorplan

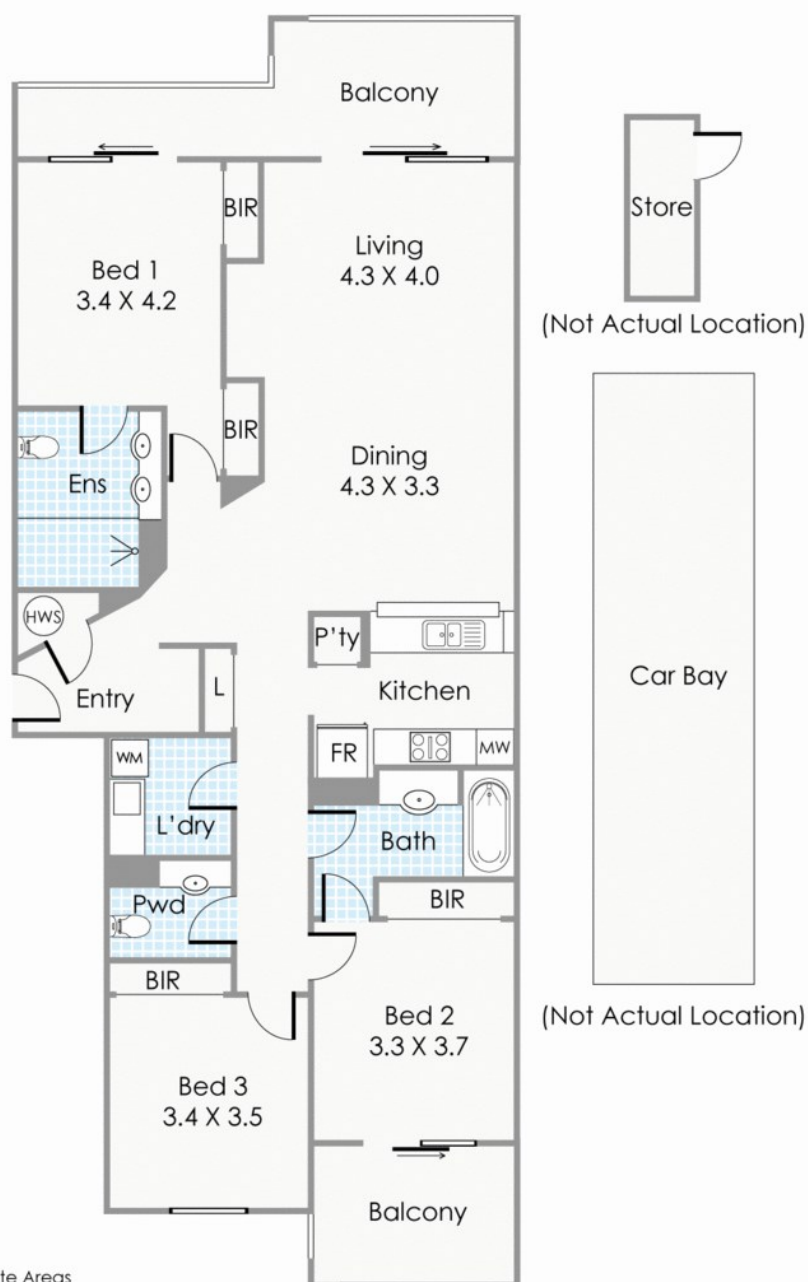

### Approximate Areas

Residence:	131m <sup>2</sup>
Car Bay:	25m <sup>2</sup>
Balconies:	22m <sup>2</sup>
Store:	3m <sup>2</sup>

Total Area: 181m<sup>2</sup>

This floorplan is for illustration purposes only to show the layout of the property. Measurements and total areas do not include or account for wall thickness or roof area under eaves. Not to be used for any other purpose.  
[www.cribcreative.com.au](http://www.cribcreative.com.au)

9/1 Henry Lawson Walk, East Perth