

00 Lignum Rd, Moama, NSW 2731

Sold - \$287,000

Residential Land

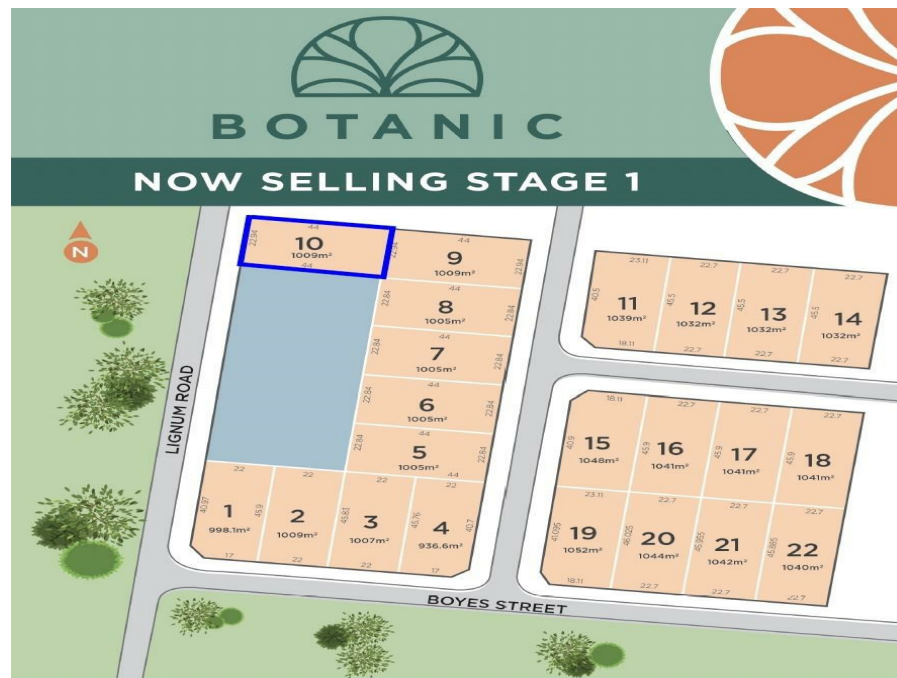

Prime Block - Botanic Views

Fantastic block on offer within Stage 1 of Botanic Views, Moama's newest Estate release. Be one of the first to build the dream in a sought after central location.

Located close to the Moama Anglican Grammar School, the Botanic Gardens, walking tracks, Moama's Sporting Precinct and the Moama Shopping Complex. Botanic Views enjoys having all these facilities right on its doorstep and is the closest land development to central Moama that has been released for many years. An amazing location for your future home. All town services with titles expected to issue in late 2022.

Open for Inspection

By Appointment.

Listed By

Rowena Ash
Phone: (03) 5482 2111
Mobile: 0414 472 962

Troy O'Brien
Phone: (03) 5482 2111
Mobile: 0418570576

