



9/2-10 Nilson Ave, Hillsdale, NSW 2036

Sold - \$1,200,000

Townhouse 3  1  1 



Two Storey 3 Bedroom Townhouse with Lock Up Garage & Two Cour

This expansive two level townhouse with 163sqm on title is on offer to the market and perfect for a family looking to get into the market.

Open for Inspection

By Appointment.

This two level townhouse is set in a very convenient location offering an active and coastal lifestyle with the choice of 4 major shopping centres, 5 beautiful beaches, 5 golf courses and the airport all only a short drive away as well as UNSW & Heffron Park leisure centre

The property itself is spread over two levels with the living quarters downstairs that open up to two courtyards and a remote control lock up garage. The kitchen offers a modern space with new electric stove top, dishwasher and stone benchtops, also included is a second WC and an internal laundry.

The sleeping quarters are on the sun drenched second level and all bedrooms come with built ins, timber flooring and air conditioning. The bathroom offers floor to ceiling tiling with a separate bath and shower recess.

There are many highlights to the beautiful townhouse and it's a must to add to your list of private inspections.

- * 3 bedrooms all with built ins, AC and timber flooring
- * Good size combined living and dining area with tiled flooring
- * Modern kitchen with stone benchtops, dishwasher & electric stove top
- * Internal laundry with WC, Remote control garage
- * Rear sun drenched courtyard as well as courtyard between entrance and lock up garage

Please contact Stephen Cachia for all enquires and to book your private inspection on 0410339988

We offer a Covid Safe service so if you have any Covid symptoms we can offer you a video inspection.

If you have no symptoms then we will require you to wear a face mask and use hand sanitizer when viewing the property

Footnote: Digital furniture has been used in the pictures as a visual effect.

Listed By

Stephen Cachia

Phone: (02) 8668 4622



Floorplan

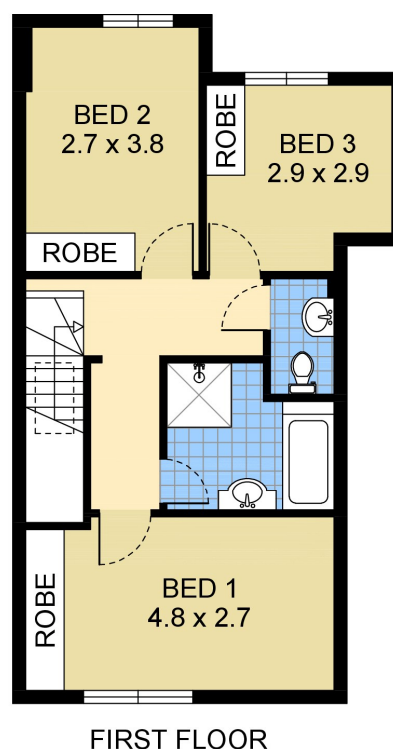

9/2-10 Nilson Avenue, Hillsdale

PLEASE NOTE:
THIS PLAN HAS BEEN PROVIDED BY EMPIRE PLANS FOR
MARKETING PURPOSES ONLY. NO RELIANCE SHOULD
BE PLACED ON THIS PLAN FOR CONSTRUCTION OR
DEMOLITION PURPOSES. EMPIRE PLANS 0402 844 843

