

3/30 Tamar St, Annerley, QLD 4103

Sold - 26/08/2021

Townhouse 2 2 2



IMMACULATELY PRESENTED TOWNHOUSE WITH VIEWS, COURTYARD AND B

Positioned in a quite yet convenient location a short stroll to Dutton Park station, 300m to Princess Alexandra Hospital, 1km to Buranda Village, 1.8km to QUT via the Eleanor Schonell Bridge and the iconic Paper Moon cafe is at the end of the street perfect for your morning coffee or vegan inspired meals.

Open for Inspection

By Appointment.

The townhouse is situated in the middle of the complex with very secure access points from the street and from the undercover garage which has two car parks allocated to unit 3. Upon entering the home, a large fenced courtyard is ideal for a sun-soaked seating area, a small pet or for storage. The courtyard has access to the two large bedrooms that are on the lower level of the townhouse. As an alternative entry via an external staircase will take you to the main living, dining and kitchen level.

You will first notice the gorgeous view this townhouse has looking toward Brisbane river. A large outdoor balcony is a perfect vantage to take in the view and creates a space for alfresco dining or entertaining and is connected to the living area through sliding doors. The living area is positioned off the large kitchen with stone bench tops, quality appliances, ample storage and natural light. The laundry is tucked neatly in behind the kitchen.

Internal stairs go down to the rooming accommodation level with carpet underfoot and a main bathroom. An ensuite services the primary bedroom whereas both rooms have built in robes, ceiling fans and external access to the lower courtyard level.

The property has recently been painted throughout and new carpets have been put downstairs. This property will be sold quickly contact your selling agent Brock Ward to secure your inspection today.

- Two story townhouse
- Two secure car parks
- Views
- Moments to train station
- Courtyard and Balcony
- Two bathrooms

Listed By

The Office

Phone: (07) 3848 7369



Floorplan

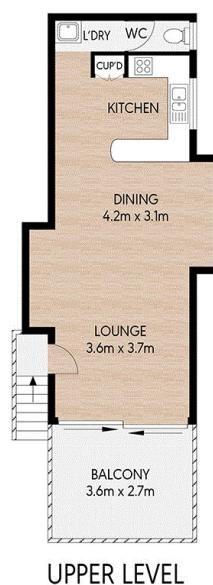

3/30 Tamar Street ANNERLEY



88m²



2 Bed



2 Bath



2 Car



DISCLAIMER | Plans are shown for marketing purposes only. All dimensions are approximate; they are subject to errors and inaccuracies and no liability will be accepted.