

155 Seib Rd, Eumundi, QLD 4562

Sold - 27/08/2021

House 3 3 3



Architecturally designed masterpiece

Welcome to 155 Seib Road, a stunning haven nestled on 5 acres with a dam close to Eumundi township and only a short drive to Noosa restaurants and the beach offering a peaceful and private retreat from the world. Affectionately known as The Farm, this luxurious property is surrounded by state forest and a large 400 acre property offering serene living and is the perfect place to rest and recharge as you create new memories with loved ones.

Open for Inspection

By Appointment.

The original cottage has been lovingly transformed from a 90sqm abode into a 245sqm architecturally designed masterpiece where old meets new in a wonderful way. An eclectic blend of antique pieces and rustic features combine to create a treat for the senses.

Every inch of this luxurious haven tells a story. The former silky oak benchtops have been made into bookshelves and fretwork has been included as a nod to the home's history. In the garden room, polished concrete floors are on show, paired with a Glasshouse granite wall installed by a Scottish stonemason.

Oversized sliding timber panels open this space to the gardens to welcome the outside in. There is room for an outdoor kitchen and dining suite or you can flow out to the paved patio and dine alfresco throughout spring and summer.

Any avid foodie will adore the designer kitchen that offers a seamless blend of life-enhancing appliances and warm finishes. You can show off your culinary skills as your friends relax at the large island or take a seat in the living room set under a soaring timber beamed ceiling.

The bedrooms are just as impeccably finished, including the plush owner's suite with a sky-high ceiling, plantation shutters, a walk-in robe and French doors that open out to a sunny patio. The secondary bedroom is light-filled and spacious, set in its own wing with the study, laundry and central bathroom.

When friends come to share in their piece of paradise, there is a one-bedroom, one-bathroom cottage with an open-plan living space and a wonderful deck with a sensational outlook and could be used as a managers accommodation. Don't miss your chance to make this hinterland gem your very own.

Listed By
Sam Walker

The Office
Phone: (07) 5447 2451



Floorplan

CENTURY 21 Conolly Hay Group

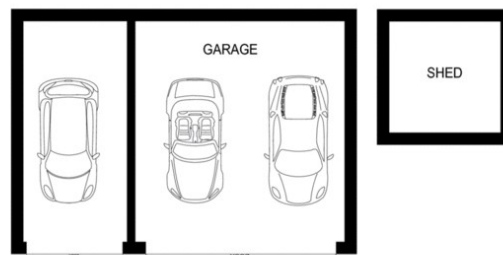
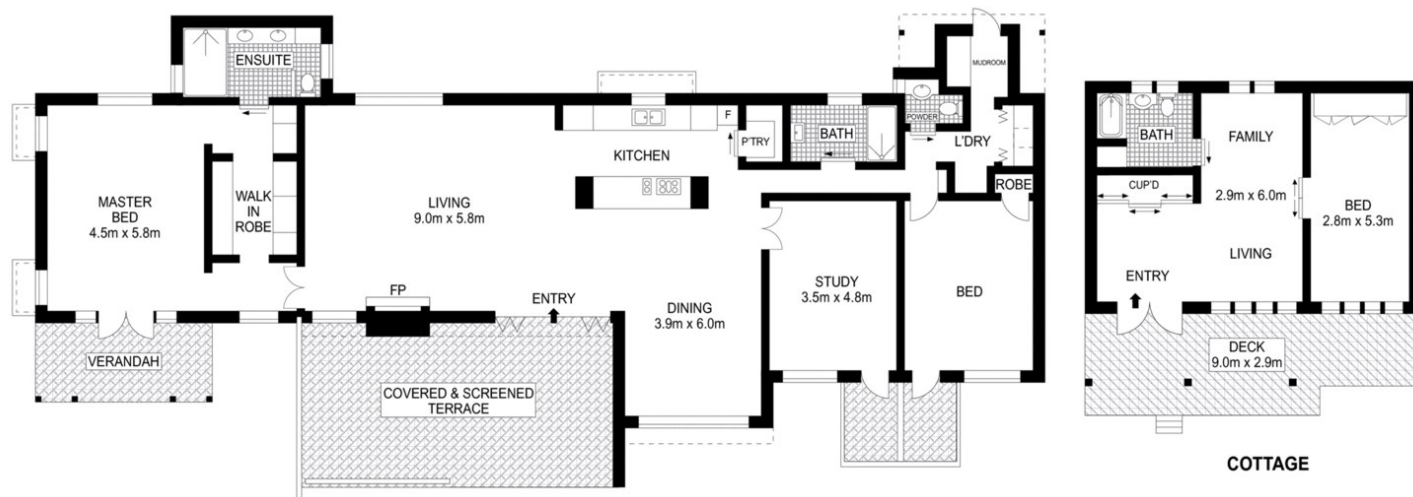

0 1 2 3 4 5

Scale in metres. Indicative only. Dimensions are approximate. All information contained herein is gathered from sources we believe to be reliable. However, we cannot guarantee its accuracy and interested persons should rely on their own enquiries.

INT: 294 m²
EXT: 129 m²

155 Seib Road, Eumundi

