

21/142 Faunce , Gosford, NSW 2250

Sold - \$267,500

Unit 1   

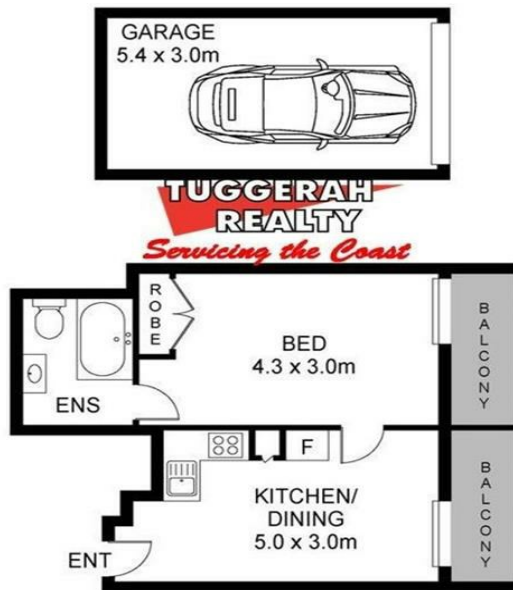

Great opportunity

Certainly, one of the best Investment opportunities as well as a very affordable first home or Retiree apartment. This one-bedroom unit with Company Title has been freshly painted, including a new reverse cycle air conditioner, two verandas with block out blinds overlooking the CBD and near new stove in the kitchen. Easy access on entry level with no stairs to worry about and being the largest in the complex with a single lock up garage included this will certainly appeal to the astute investor.

Open for Inspection

By Appointment.

Located 185 meters walk to Gosford train station, approximately 310 meters walk to the imperial Centre shopping complex and just over 1200 meters walk to the Brisbane waterfront and parks.

The property is being sold under company title with the fees all-inclusive of council rates, water usage and service fees, general building repairs, pest/vermin control, building insurance, and more.

* When inspecting this property, it is mandatory to wear a face mask and to use either hand sanitizer or latex gloves*

Listed By

Glenn Harrison
Phone: (02) 4352 1950

Holly Harrison

