

7 Henry Dr, Altona Meadows, VIC 3028

Sold - 8/05/2021

House 3 2 2



An Outstanding Altona Meadows Opportunity

LJ Hooker Point Cook presents 7 Henry Drive, Altona Meadows. An original property in brilliant condition, this single-storey residence offers unmeasured opportunity for first home buyers, downsizers and investors. Perfectly livable, this property offers enormous renovation potential, the floorplan comprising multiple living zones, three bedrooms and two bathrooms, set upon a 478m2 (approx.) block. Perfectly located within the quiet and leafy streets of Altona Meadows, this sought-after location is just moments from local shops, schools and parklands.

Open for Inspection

By Appointment.

- This property offers an abundance of living space throughout, beginning with formal lounge and dining spaces and flowing with ease to the open plan family and meals zone. The interiors are neutral in tone and fully carpeted throughout, offering optimum comfort for everyday living.
- Well-integrated with both the family and meals spaces, the kitchen offers original fittings and fixtures, including a gas cooktop and wall mounted oven. Wrap around countertops provide excellent preparation space and include a convenient breakfast bar, while overhead cabinetry and a full-sized pantry provide ample storage.
- Accommodation begins with the spacious master suite, located at the front of the home and boasting oversized picture windows, a walk-in-robe and a private ensuite. Offering superb separation, two additional built-in bedrooms are located at the rear of the home, each sharing access to the family bathroom, complete with a bathtub and separate toilet.
- The low maintenance grounds are fully fenced, the generous backyard with plenty of scope for an extension or swimming pool, while a paved alfresco adjoins the family room.
- Further highlights include a double carport, separate laundry, wall heating, split system air conditioning, external roller shutters and a garden shed.

This brilliant location offers peaceful and convenient living, opposite the picturesque Bruce Comben Reserve and within walking distance of Central Square Shopping Centre. Local schools include Seabrook Primary School, Altona Meadows Primary School, Altona Green Primary School and Laverton P-12 College, while pristine recreational reserves include AB Shaw Reserve and Truganina Park. Well positioned for commuters, this location offers easy access to both Aircraft and Laverton Stations, bus services and the M1 Princes Freeway.

Note. All stated dimensions are approximate only. Particulars given are for general information only and do not constitute any representation on the part of the vendor or agent.

Listed By

The Office

Phone: (03) 9975 7080

Paul Caine



Floorplan

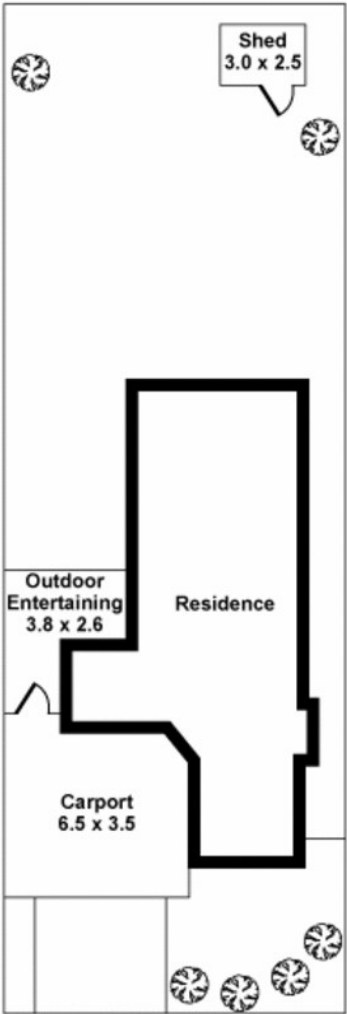

SITE PLAN

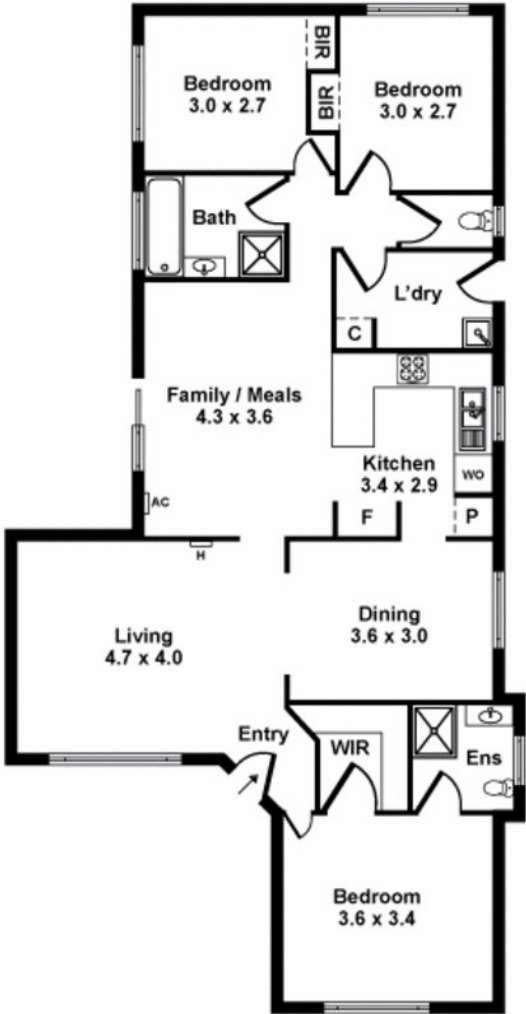

FLOOR PLAN

Whilst every attempt has been made to ensure the accuracy of this floorplan, measurements of doors, windows, rooms and any other items are approximates only. The producer or agent cannot be held responsible for any errors, omissions or misstatements. This plan is for illustrative purposes only and should be used as such.