

Lot 31/16-24 Bayes Rd, Logan Reserve, QLD 4133

Sold - 11/04/2022

Residential Land

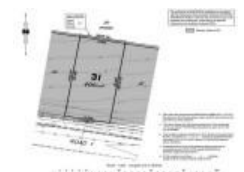
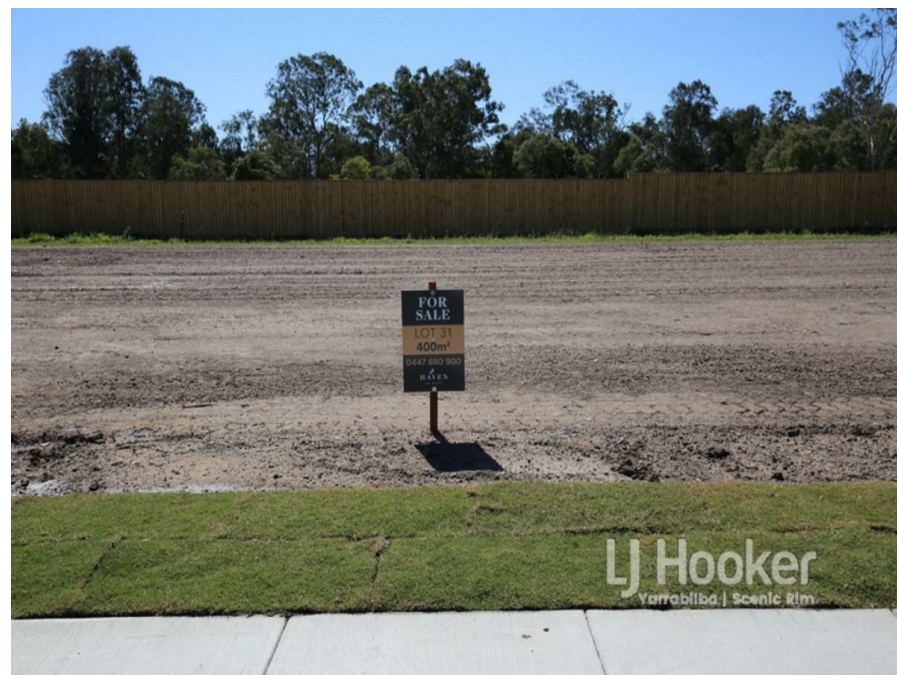

SOLD By Mark Todd 0447 880 900

Lot 31 / 16-24 Bayes Road, Logan Reserve

The Haven On Bayes is a new 55 Lot Development made up of blocks ranging from 325m2 to 625m2. With a variety of blocks for sale, this estate is perfect for first home buyers, investors or owner occupiers alike.

Ideally positioned with the M1 and Logan Motorway within just minutes drive, this estate is centrally located between Brisbane and the Gold Coast making this location perfect location for everyday commuters.

Within close proximity but not limited to:

- 6 min drive to Marsden Park Shopping Centre
- 7 min drive to Crestmead State School
- 7 min drive to Marsden State High School
- 11 min drive to Waterford Plaza
- 13 min drive to Grand Plaza Shopping Centre
- 12 min drive to Logan Hospital
- 34 min drive to Brisbane CBD
- 51 min drive to Gold Coast

All Lots will be selling off "Disclosure Plan" giving buyers the opportunity to secure their land while having ample time to focus on finalising their house designs with a builder of their choice.

If this estate interests you and you would like some further information, call Mark Todd on 0447 880 900!

Open for Inspection

By Appointment.

Listed By

Mark Todd

