

## 2-4 Leafy Cl, Redlynch, QLD 4870

Sold - 25/01/2021

House 4  2 



### Tranquil Leafy Setting with Stunning Mountain Views

Looking to escape suburbia but still need to be an easy 10 minute drive to local shopping, popular schools and amenities and 25 minute drive to the Cairns CBD or the Northern Beaches?

This acreage property (4723sqm) is all about capturing a lifestyle where privacy is assured, natural beauty is in abundance and tranquility guaranteed.

Impeccably maintained and presented an inspection of this residence will not disappoint!

Impressive features include:

- \* Cleverly designed in an elevated position to easily access lawn area at the rear of the home and glorious mountain views
- \* Two separate living areas with an open plan living and dining area and a family room
- \* All internal living areas open to the expansive undercover deck - the perfect spot to absorb the leafy rainforest surrounds and enjoy the mountain views
- \* An all year-round freshwater creek runs through the property
- \* Central well-appointed kitchen with stainless steel appliances, breakfast bar and servery to the deck
- \* Master bedroom privately positioned away from other bedrooms and complete with private balcony, walk-in robe and ensuite
- \* Three further good size bedrooms each with built-in wardrobes and private access to an undercover deck
- \* Private rear deck extending off the internal living with an aspect of the rear yard
- \* Internal laundry

#### Listed By

Nadine Edwards

Phone: (07) 4053 9999

Mobile: 0423 602 606



**Open for Inspection**

By Appointment.

## Floorplan

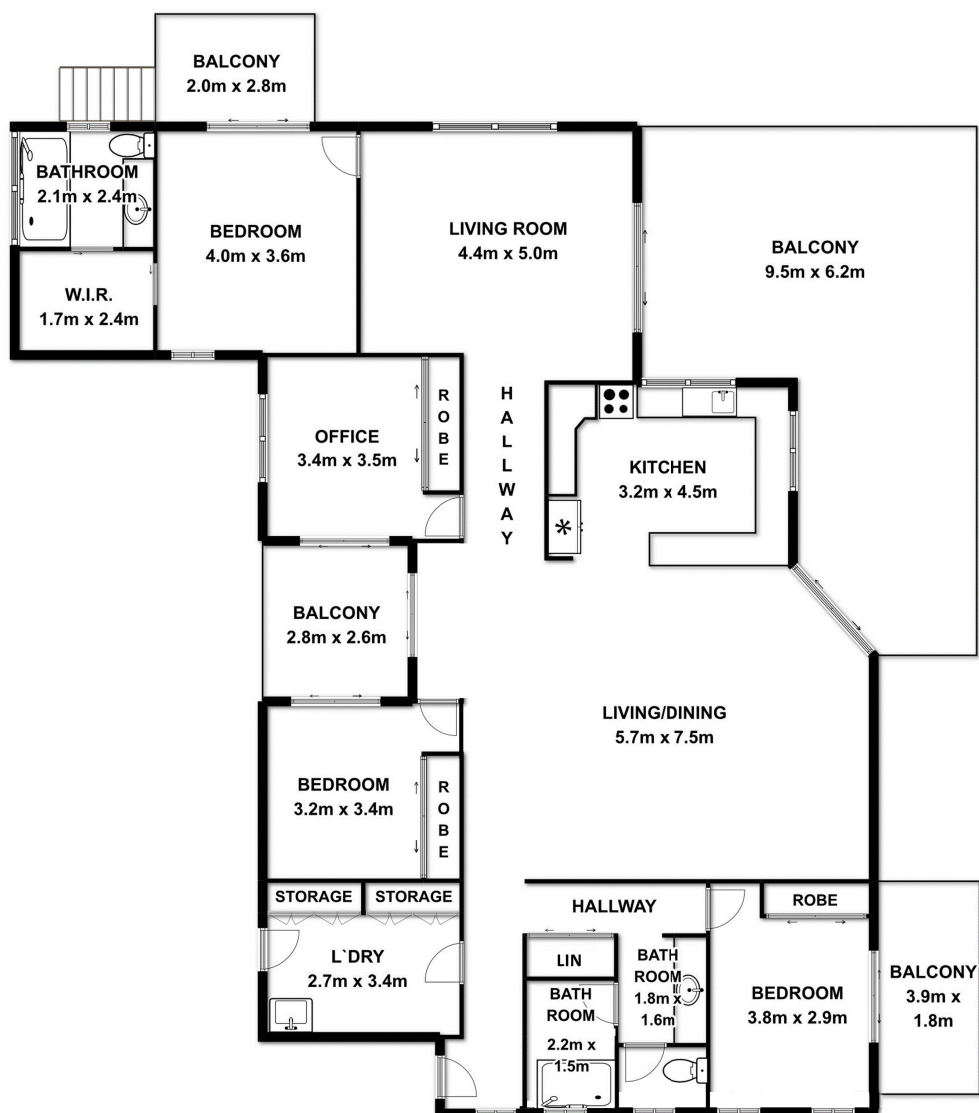

## FLOOR PLAN

Plan is not to scale and is indicative of layout. It is for illustrative purposes only. All room sizes and dimensions shown on this plan, including, but not limited to, doors, windows, cabinets are approximate.  
Property Shots Australia gives no guarantee to the accuracy of the document.

# 2-4 Leafy Close, Redlynch