

1/2a Nicole Cl, Watanobbi, NSW 2259

Sold - 2/06/2020

Unit 4 2 1



## Sold by LJ Hooker Toukley 4396 6999

Spacious modern townhouse in a small complex of four boasting style, modern living and set in an excellent location.

The townhouse consists of four generous bedrooms, all with built-ins and ceiling fans with the master bedroom having an ensuite. Open plan living and dining areas with reverse cycle air conditioning, capture plenty of natural light and the gourmet kitchen has gas cooking and stainless steel appliances.

The bathroom is modern and design and you have the added bonus of a third toilet in the laundry.

For entertaining you can step outside to your own private courtyard area offering plenty of space and comfort. You even have internal access from the remote lock up garage into the townhouse.

Situated close to Wyong train station, popular cafes, public transport, hospital, schools, Westfield shopping centre and the M1 makes this the perfect opportunity for first home buyers, families and investors!

**\*\*PLEASE NOTE:** Due to the current COVID-19 pandemic, LJ Hooker Toukley will have restricted numbers of people at scheduled open homes. Private viewings are still available via virtual viewings or face-to-face (subject to COVID-19 health conditions). Please contact the agent to organise an appointment.

**DISCLAIMER:** This advertisement contains information provided by third parties. While all care is taken to ensure otherwise, LJHooker Toukley does not make any representation as to the accuracy of any of the information contained in the advertisement, does not accept any responsibility or liability and recommends that any client make their own investigations and enquiries. All images are indicative of the property only.

### Listed By

David Spiers  
Phone: (02) 4396 6999  
Mobile: 0412 070 379

### Open for Inspection

By Appointment.



## Floorplan

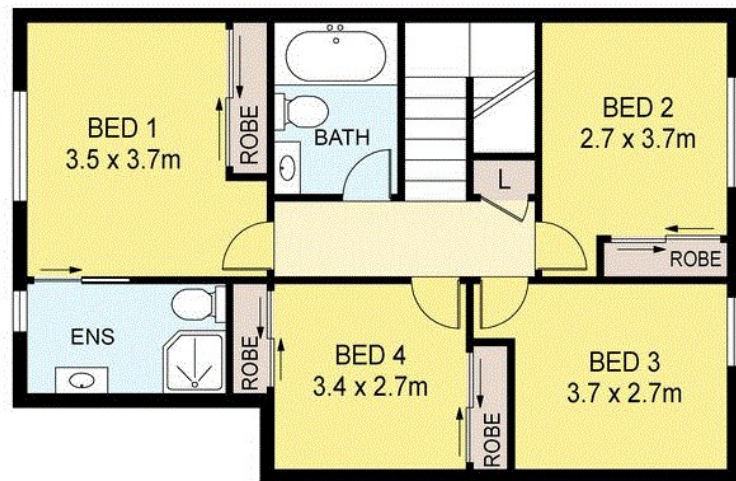

FIRST FLOOR



GROUND FLOOR



Scale in metres. Indicative only. Dimensions are approximate. All information contained herein is gathered from sources we believe to be reliable. However we cannot guarantee its accuracy and interested persons should rely on their own enquiries.

1/2a Nicole Close, Watanobbi

