

1-6/30 Marlowe St, Campsie, NSW 2194

Sold - \$2,675,000

Other 6 



BLOCK OF 6 X 2 BEDROOM UNITS

A rare opportunity to purchase this blue chip investment that is situated in the heart of Campsie and located within a short walking distance to schools, station and shops. This is sure to pique the interest of those with an eye on current property trends. Features include:

- * 6 x 2 bedroom units
- * Eat in kitchens
- * Balconies
- * Carspaces
- * Minutes from shops and train station
- * Land area 645sqm approx
- * R4 high density zoning
- * Fully tenanted

Details: George Vourlas 0412 074 222

Open for Inspection

By Appointment.

Listed By

George Vourlas

Phone: (02) 9789 2888

Mobile: 0412 074 222



Floorplan

robert r
andrew
campsie

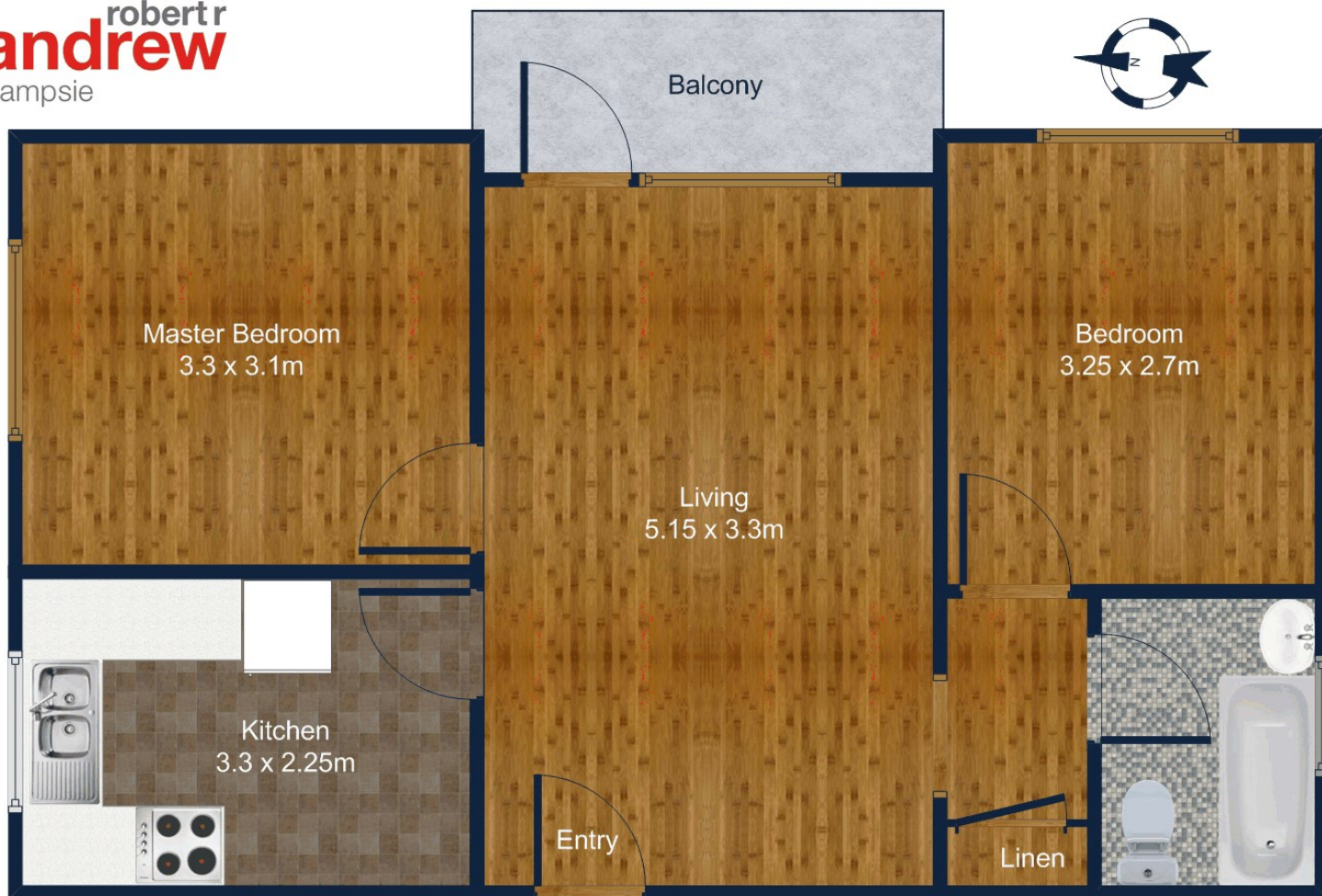

1 & 4/30 Marlowe St, Campsie

This plan is for illustrative purposes only, dimensions are approximate, it does not constitute part of any legal document or commercial contract for the sale of this property.

FLOOR
& PHOTO
0420 310 710