



4 Inkster St, Taperoo, SA 5017**Leased - \$480**Townhouse 3  2  1 **BOND PAYMENT PENDING - APPLICATIONS CLOSED**

OPEN TO VIEW THURSDAY 12TH MAY AT 4:30PM - 4:45PM.

Property is currently tenanted no other opens available at this stage.

APPLICATIONS FORMS CAN BE FOUND VIA THIS LINK : semaphore.century21.com.au/information/1214/rental-application

Please copy the link into Google browser and download to complete.

Once completed , please email your completed form to ORIELLA: propertymanager1@semaphorerealestate.net.au

Walking distance to the beach with conveniences such as the shops & train only a short walk away.

Main bedroom is luxurious & spacious and features a huge private balcony and stylish ensuite bathroom.

Open plan living room leading out to the outdoor entertaining area

Bosch appliances including oven, gas cook top & dishwasher.

Ducted reverse cycle air-conditioning with controllable zones

Stylish chef inspired kitchen.

Fully landscaped with watering system.

Undercover outdoor living area.

2 bathrooms plus 3 toilets.

Lock up garage plus second car park in driveway with nice size courtyard areas.

Plenty of storage including built-in robes.

NO PETS PLEASE

Please phone Oriella Cianci on 0488 972 902 for further information if required.

RLA 123460

Listed By

The Office

Phone: (08) 8242 1233

Open for Inspection

By Appointment.



Floorplan

4 Inkster Avenue,
TAPEROO

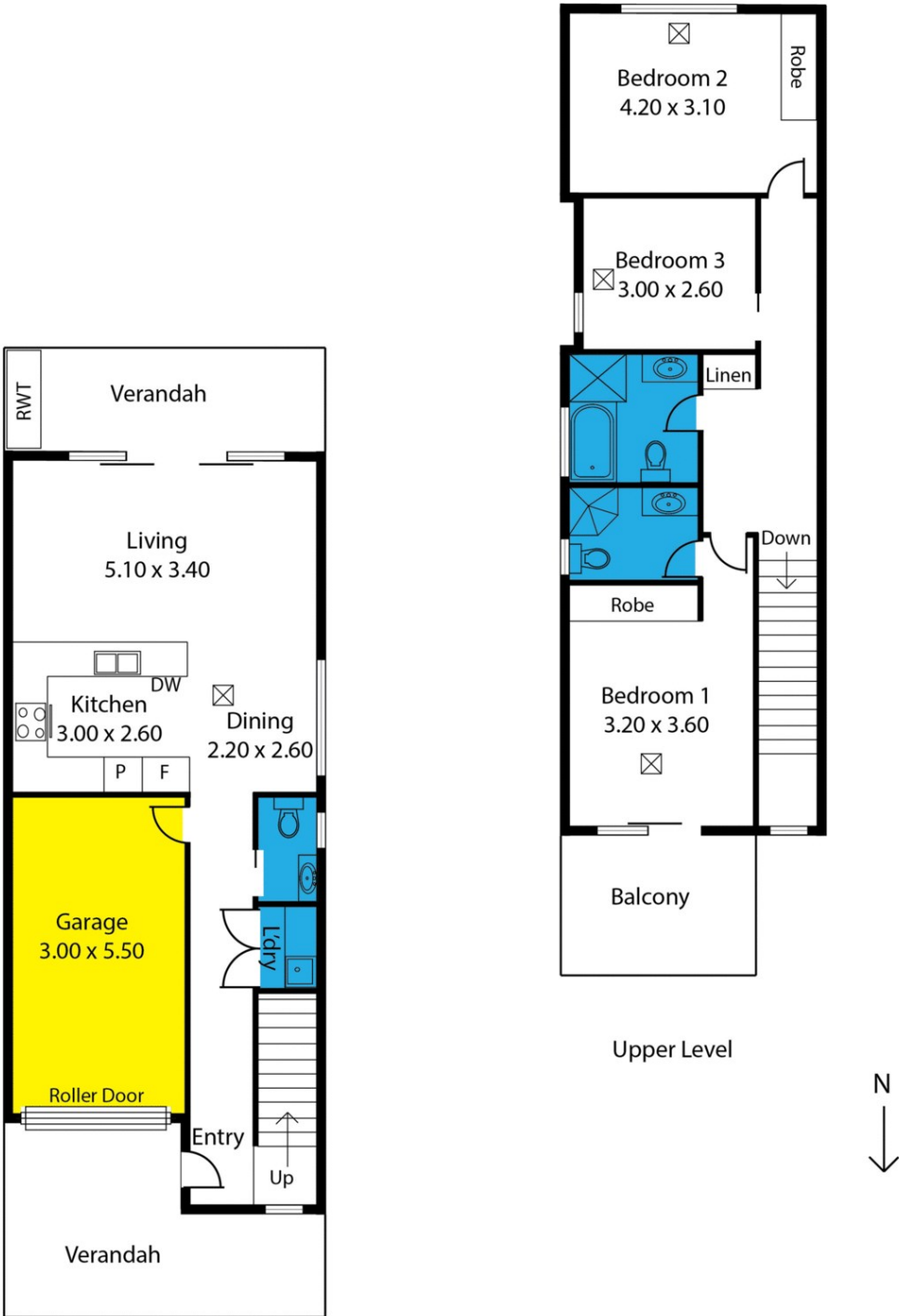

Living:	117.78 sqm
Balcony:	8.25 sqm
Verandah:	25.12 sqm
Garage:	17.36 sqm
Total:	168.51 sqm

PRIVACY ACT. COLLECTION NOTICE FOR OPEN INSPECTIONS
Century 21 Beachside and Lakes use personal information collected from you during open inspections. We may also use that information to contact you with respect to this property and others which we believe may interest you. In providing the information you agree to this use unless you advise us differently. If the information is not provided we may not be able to provide an effective service to you, other than in the circumstances allowed under the Privacy Act. We do not disclose information of this kind to other people.

This floorplan is for illustration purposes only and all measurements are approximate. Any fixtures shown may not necessarily be included in the sale contract and it is essential that any queries are directed to the agent. Any information that is intended to be relied upon, should be independently verified. While every endeavour has been made to verify the correct details in the publication neither the agent, vendor or contracted illustrators take any responsibility for any omissions, wrongful inclusions or topographical error which may occur in this drawing.

Floorplan produced by Open2view

