

60 Portman St, Oakleigh, VIC 3166

\$50,000 + GST + Outgoings

Retail Shop



## MODERN RETAIL IN THE HEART OF OAKLEIGH

\* Retail shop or office of 160m2.

\* As new with modern fit out including central heating & cooling, separate kitchen & toilets & rear courtyard.

\* Centrally located amongst the best Oakleigh has to offer; including shops, cafes, parking & train station.

Open for Inspection

By Appointment.

### Listed By

The Office

Phone: (03) 9544 8888



Floorplan

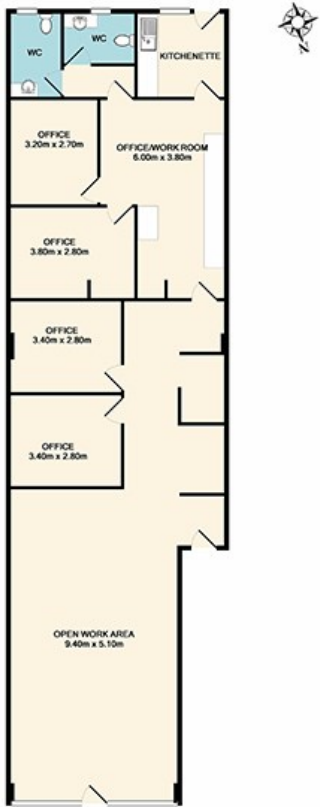

While every attempt has been made to ensure the accuracy of the floor plan contained here, measurements of areas, volumes, rooms and any other items are approximate and no responsibility is taken for any error, omission, or misstatement. This plan is for illustrative purposes only and should be used as such by any prospective purchaser. The vendor, solicitor and real estate agent have not been asked and do not guarantee as to their accuracy or otherwise and do not give any warranty.