



12/130 Lighthouse Rd, Byron Bay, NSW 2481

Sold - \$2,300,000

Townhouse 3  2  2 



## PRESTIGIOUS BLUE CHIP LOCATION

Spread over two fabulous levels, this spacious apartment is designed to capture the sweeping uninterrupted view and summer breezes.

Boasting a premier address this apartment features, double remote garage with internal access, spacious light filled interiors with an open plan design that flows out onto the private north facing patio and courtyard.

The upstairs level consists of additional living area plus three bedrooms with an impressive master suite leading out to both front and rear decks designed to capture not only the spectacular views of the bay but also the Byron hinterland.

A simply perfect elevated location in Byron Bay's elite precinct can be yours!! Such an ideal location where you can literally stroll across to the beach, walk into Byron Bay's town centre and enjoy the convenience and casual lifestyle Byron has to offer.

This is truly a sensational investment and would suit the most savvy purchaser.

To arrange an inspection of this fabulous property, please contact Janis Perkins on 0438 841 122.

**Open for Inspection**

By Appointment.

Amazing views over the Bay  
In ground Pool in complex  
Double lock up garage with internal access  
Built-ins  
Two bathrooms  
Separate powder room  
Air conditioning  
3 bedrooms  
2 living areas

### Listed By

Peter Stone  
Phone: (02) 6655 1795  
Mobile: 0413 111 621



## Floorplan

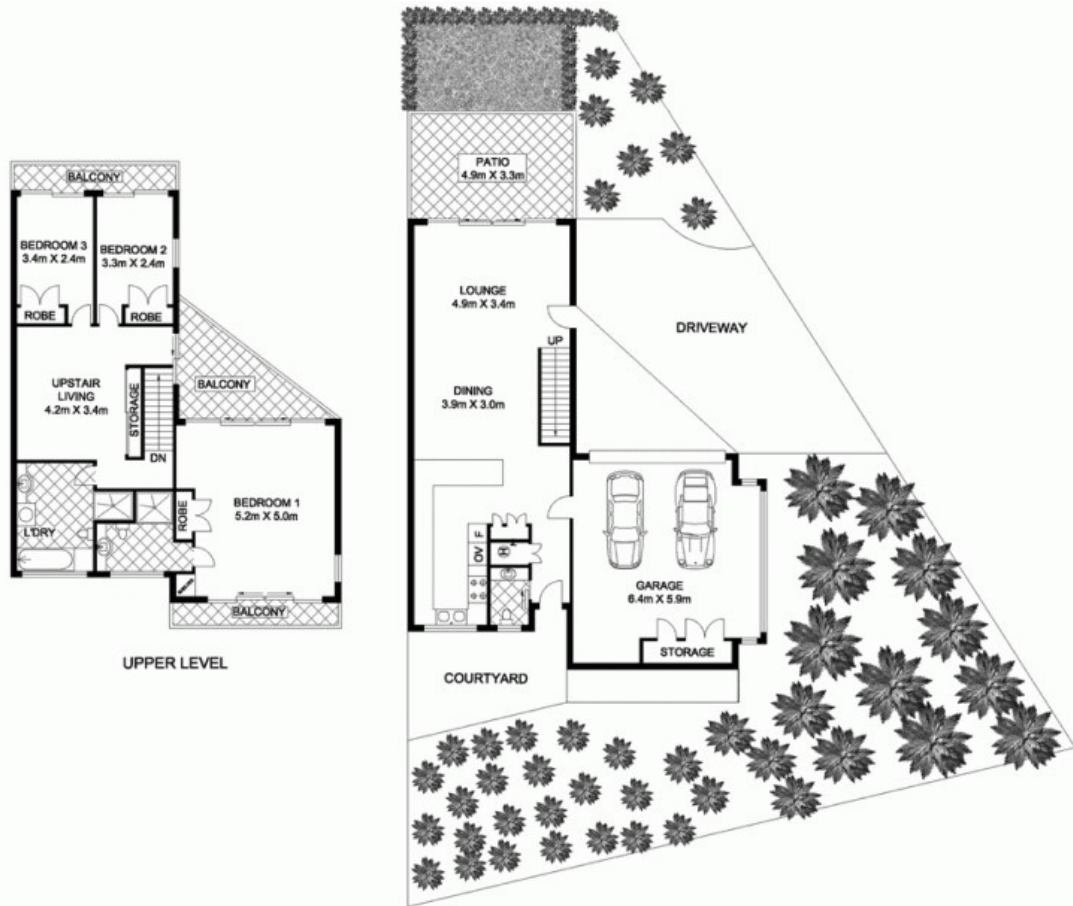

Scale: in meters, indicative only. Dimensions are approximate. All information contained herein gathered from sources we believe to be reliable. However we cannot guarantee its accuracy and interested persons should rely on their own enquiries.

INT : 146.10m<sup>2</sup>  
EXT : 37.09m<sup>2</sup>  
GARAGE : 36.32m<sup>2</sup>



**12/130 Lighthouse Road Byron Bay**