

Unit 39/24 Garling Rd, Kings Park, NSW 2148

\$2,108 Per Month

Warehouse

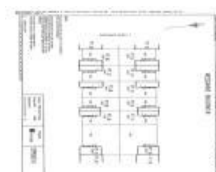

MODERN INDUSTRIAL WAREHOUSE

This warehouse has the below features:

- * Approx. 190sqm Floor space (incl. 31sqm office)
 - * Customer or staff parking
 - * Strategically placed within a kilometre to the M7 Motorway.
 - * Located approx 30 mins from the Sydney CBD.
 - * The site enjoys two street access - Garling and Valediction Roads - allowing drive through access for all vehicles.
 - * The unit is complete with high standard, low maintenance internal finishes with fully carpeted and air-conditioned office space.
 - * High clearance warehouse component.
 - * Ample onsite parking is provided within this gated secure estate.
- Available 14/09/2017

Open for Inspection

By Appointment.

Listed By

David Martignago

