

Unit 10/2 Maple Ave, Klemzig, SA 5087

Sold - 27/04/2025

House 2 1 1



Fantastic Opportunity in a Prime City-Fringe Location

Don't miss this fantastic and affordable opportunity to secure a home in one of the most sought-after postcodes on the fringe of Adelaide. Perfectly suited to investors, downsizers, first-time buyers, or those seeking a low-maintenance lifestyle, this well-maintained unit offers incredible value within a tidy, single-level complex just 8kms from the heart of the city.

Open for Inspection

By Appointment.

The home features two generously sized bedrooms, both serviced by a spacious central bathroom complete with a bath and internal laundry facilities. The bright, airy living area is ideal for relaxing or entertaining, with plenty of room for a dining setting. The adjoining kitchen is neat and practical, offering ample storage and bench space.

Additional highlights include a split-system air conditioner for year-round comfort and a dedicated carport space conveniently located next to the home.

Enjoy the lifestyle benefits of a prime location just moments from OG Road and the picturesque Linear Park, with a selection of renowned schools, public transport, shopping centres, and main arterial roads all within easy reach.

This is an excellent opportunity to enter a thriving market in a desirable location — whether as a savvy investment, comfortable downsizer, or welcoming first home.

Certificate of Title and Form Ones available upon request

Home Built: 1973

Strata Titled

Title: Volume 5051 Folio 725

Zoning: GN - General Neighbourhood

Council: Port Adelaide Enfield Ph. 08 8405 6600

Strata Rates: \$525.00 per quarter

Council Rates: \$1,090.85 Per year

All sizes, lengths, fees and distances mentioned above are approximate. LJ Hooker Prospect takes no liability for any incorrect details.

08 8405 124

Listed By

Harvey Bloomfield

Mobile: 0410 658 617



Floorplan

10/2 Maple Avenue,
KLEMZIG

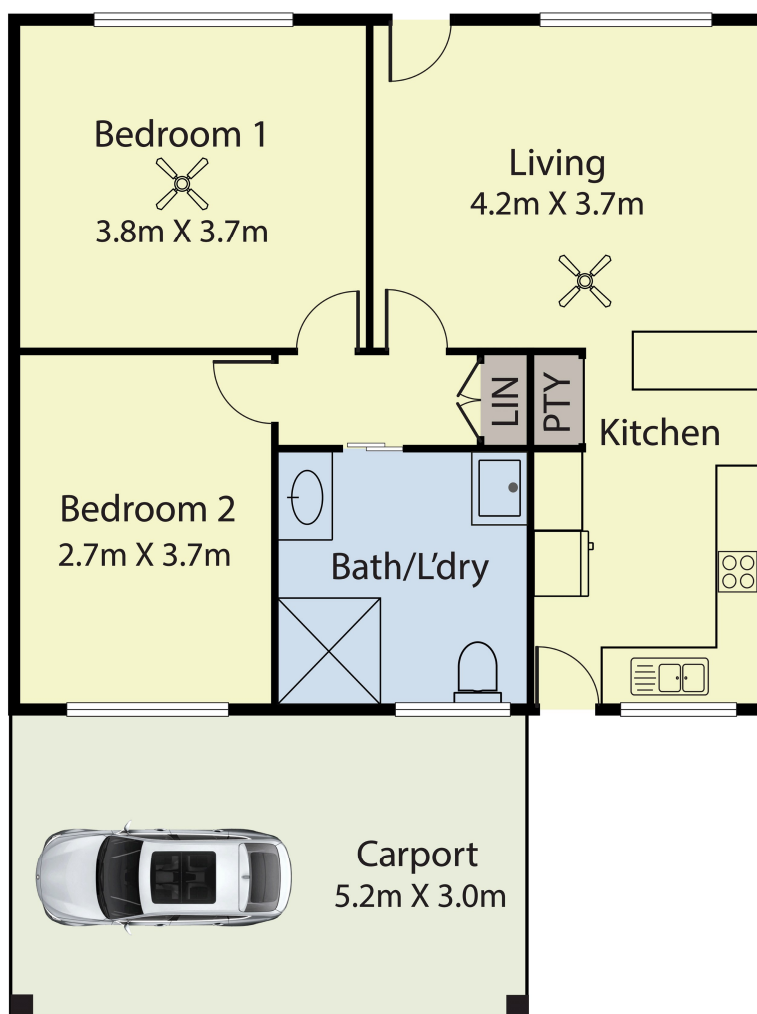

This Drawing is for illustration purposes only. All measurements are internal and approximate. Details intended to be relied upon should be independently verified.

Produced by **pixsnap**