

Unit 1/18 Crisp St, Omeo, VIC 3898

Sold - 15/09/2025

Unit 2 1 1



### AFFORDABLE HIGH-COUNTRY LIVING

Nestled on the edge of the Omeo township, Unit 1 at Mount Mesley Lodge presents an exceptional opportunity to enter the high-country market. The unit boasts captivating views over the surrounding farmland and mountains, providing a serene backdrop for your country retreat.

Inside, the unit offers a spacious, light-filled atmosphere, creating a welcoming and comfortable living space. The open-plan living and dining area is enhanced by the warmth of wood heating, making it the perfect place to unwind. The kitchen is well-equipped, and the main bedroom offers a peaceful haven. The bathroom and laundry are thoughtfully designed for convenience, while the expansive loft upstairs offers versatility, ideal as a games area or a large sleeping space for guests.

Enjoy the convenience of a carport and a wide balcony that invites you to relax and take in the magnificent views. Positioned within walking distance to historic Omeo, and just a short drive from Mt Hotham and Dinner Plain, the location offers easy access to the best of the Victorian High Country. For those who enjoy outdoor adventures, explore the newly opened Mountain Bike Trails or the region is known for its superb trout fishing.

Whether you're looking for a charming country escape, a permanent residence, or a property that offers potential rental income of approximately 5.7%, this unit is being sold fully furnished and is an opportunity not to be missed. Make this delightful unit your own and experience the beauty and tranquillity of high-country living.

**Open for Inspection**  
By Appointment.

Listed By  
Kelly Quirke



Floorplan

1/18 Crisp Street, Omeo

This floor plan including furniture, fixture measurements and dimensions are approximate and for illustrative purposes only. LJ Hooker gives no guarantee, warranty or representation as to the accuracy and layout. All enquiries must be directed to the agent, vendor or party representing this floor plan.



DOWNSTAIRS

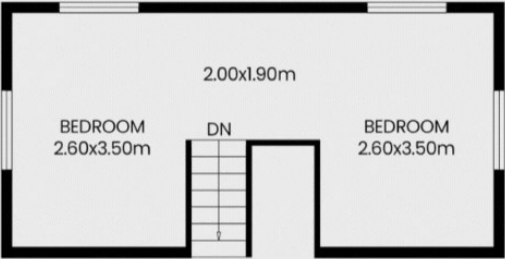

UPSTAIRS

