

Shop 3/19-21 Princes Hwy, Fairy Meadow, NSW 2519

\$2,020/month + GST

Retail Shop



High Exposure Retail/Commercial Space in the Heart of Fairy

Positioned on the bustling Princes Highway with excellent street frontage, Shop 3 offers a prime opportunity for businesses seeking visibility, accessibility, and convenience.

Key Features:

- 42 sqm* of flexible open-plan space
- Large glass frontage with signage potential
- Air-conditioned interior
- Rear access and 1x parking
- Suits retail, office, or service-based use (STCA)
- Surrounded by established businesses and foot traffic
- Public transport and ample street parking nearby

This highly visible location sits just moments from Fairy Meadow's retail core, with strong daily traffic flow and close proximity to Woolworths, cafes, medical centres, and public transport.

Enquire now to inspect and secure this versatile commercial opportunity.

Open for Inspection

By Appointment.

Listed By



Chris Styliis
Phone: (02) 4229 8600
Mobile: 0419 211 331



Con Papadopoulos
Phone: (02) 4229 8600
Mobile: 0408 604 040



Floorplan

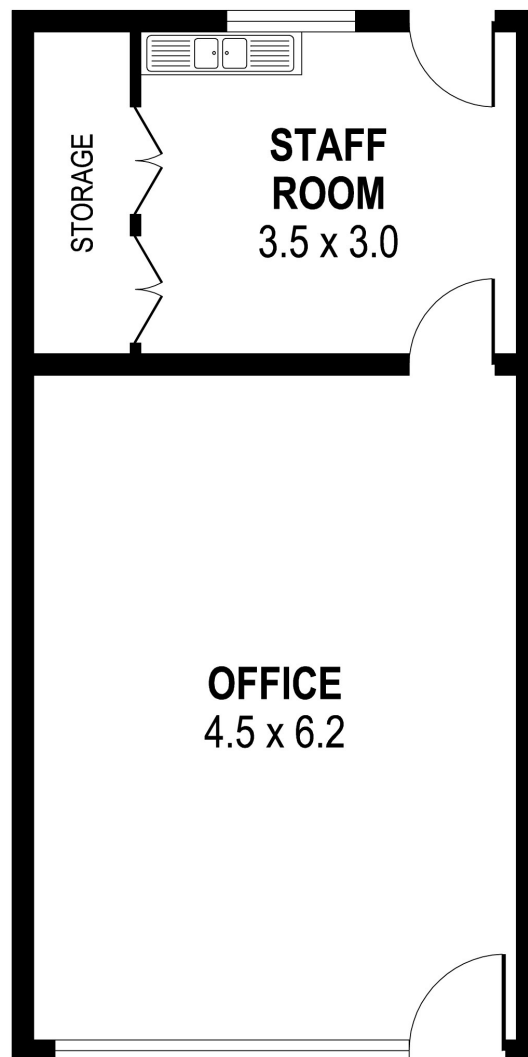
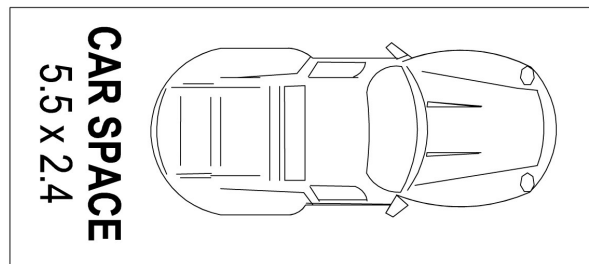

PLANS SHOWN ONLY INDICATIVE OF LAYOUT. DIMENSIONS ARE APPROXIMATE.

INT : 42m²
CAR SPACE : 13m²

SHOP 3, 19-21 PRINCES HIGHWAY

FAIRY MEADOW