

Shop 2/335 Crown St, Wollongong, NSW 2500

\$23,100 pa

Office Suite



High Profile Wollongong Location

Positioned at the "Gateway to the City" is this 40m2 approx shop/offices, surrounded by high performing businesses. Close to Wollongong's main railway station with pedestrian access to and from, only meters away. Very visible location at a major T intersection, so ensures a high profile to any business. CBD Commercial Core B3 Zone, allows a myriad of uses (STCA).

Open for Inspection

By Appointment.

Listed By



Con Papadopoulos
Phone: (02) 4229 8600
Mobile: 0408 604 040



Chris Stylis
Phone: (02) 4229 8600
Mobile: 0419 211 331



Floorplan

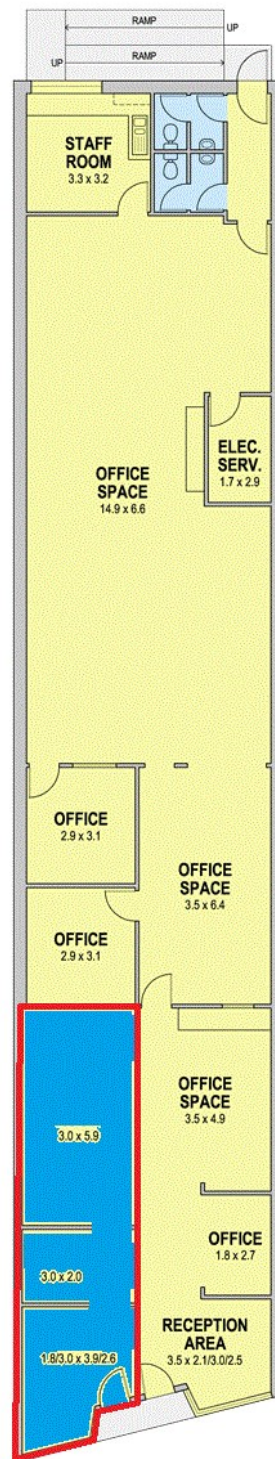

335 Crown Street, Wollongong, NSW
Net Internal Area: 239m² (approx.)



Disclaimer: Design Junkies Graphic Imagery whilst preparing this document for the use by The Real Estate Products Group Pty Ltd clients used our best endeavours to ensure that the information contained in this document is true and accurate, but accept no responsibility and disclaim all liability in respect of any errors, omissions, inaccuracies or mis-statements contained in this document. Prospective purchasers should make their own enquires to verify the information contained in this document.
Residence Area includes all external walls, outdoor areas and outdoor structures.