

**Shop 2/19 Princes Hwy, Fairy Meadow, NSW 2519**

**\$24,000 pa + GST**

Retail Shop



## High Exposure Retail

Bright and fresh retail space in the centre of the Fairy Meadow shopping strip. Positioned on a busy intersection and surrounded by other bustling businesses, it is position perfect.

This fresh space offers fantastic street frontage, with huge front window perfect for retail display. Inside is light filled with timber look flooring across the main space. At the rear is a space that can be sectioned off if required. The space is also serviced by rear access from the on-site parking.

### Key Features

- 42 sqm approx. floor space.
- Fresh finishes through out.
- Off Street staff parking.
- Suited to either retail or office usage.
- Huge street exposure.

### Open for Inspection

By Appointment.

### Listed By

Chris Stylis  
Phone: (02) 4229 8600  
Mobile: 0419 211 331



Floorplan

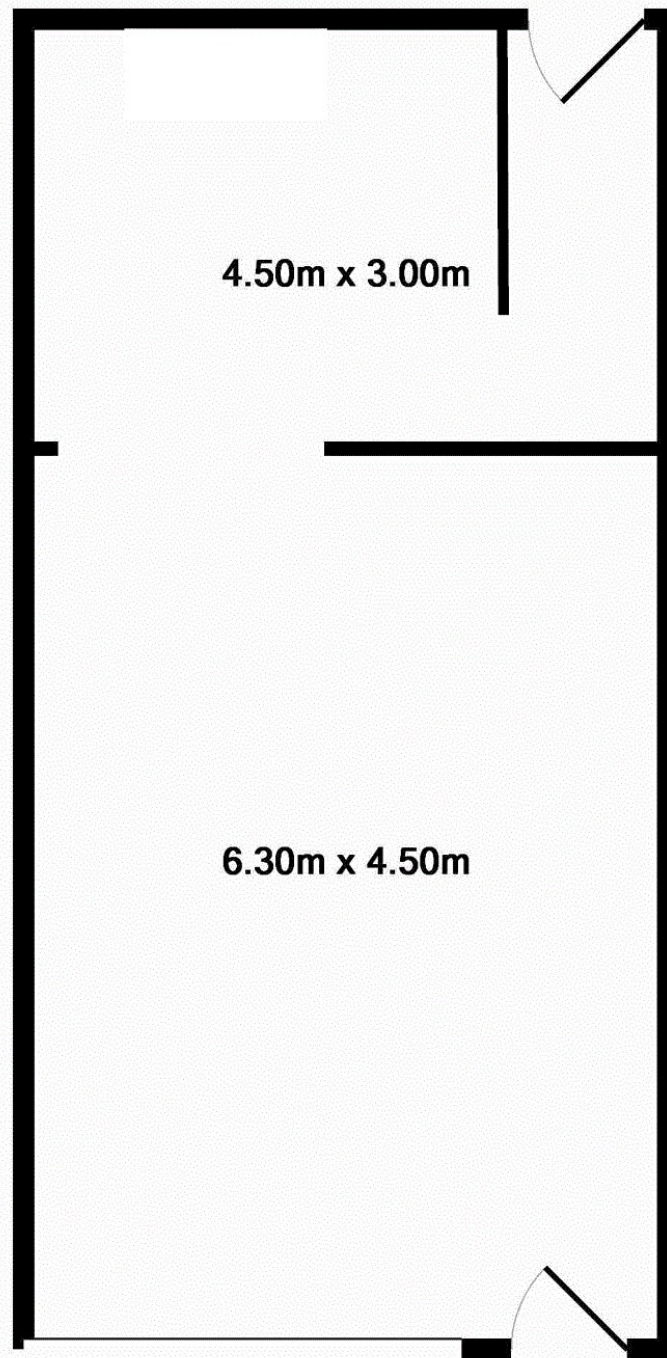

Shop 2 / 19 - 21 Princes Highway, Fairy Meadow.  
Total Approx. Floor Area - 41.9 sqm