

SHOP 490 Bunnerong Rd, Matraville, NSW 2036

DEPOSIT TAKEN

Retail Shop



DEPOSIT TAKEN

FANTASTIC EXPOSURE - DOUBLE FRONTED MODERN SHOP - 3 PARKING SPACES - TOTAL 138 sqm

Located directly opposite Peninsula Village Shopping Centre and on the busy shopping strip of Matraville, this highly exposed retail shop offers immediate business opportunities for astute operators and features:

- Modern Internal shop 83m².
- 2 x Toilets - 7 sqm. Storage Room - 7 sqm.
- Rear lane access to 3 car spaces - 41sqm
- Glass shopfront with signage potential
- 2 x split system air conditioning units
- Kitchenette + Filing Room
- Suitable for any professional business - Retail/Medical/Office
- Council car park at rear

INSPECT BY APPOINTMENT

Open for Inspection

By Appointment.

Listed By

Sue Hetherington
Phone: (02) 9599 1511
Mobile: 0407 991 511



Listing Number: 3449388

Floorplan

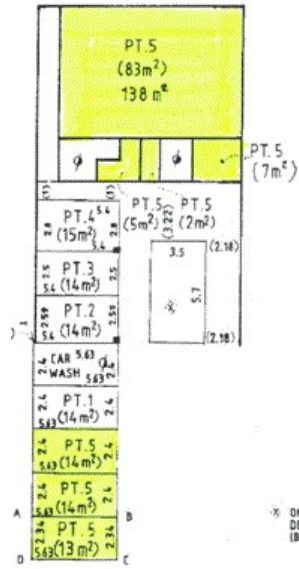

GROUND FLOOR