

7/735 New South Head Rd, Rose Bay, NSW 2029

\$895 \*\*\*DEPOSIT TAKEN\*\*\*

Apartment 2  1 



## Vibrant Village Living By The Harbour

Century 21 Armstrong-Smith - Bondi Junction are proud to present this wonderful apartment offering the convenience of village living, this stylish contemporary apartment is located amid Rose Bay's cosmopolitan shops and cafes. Capturing glimpses of the glistening harbour that lies directly across the road, this secure, low-maintenance address is found on the second floor of a boutique security building of 12. It's the perfect Eastern Suburbs lifestyle home. Walk out your door to enjoy picturesque morning walks by the water, lunch at bustling local restaurants and a great community atmosphere, with Royal Sydney Golf Club on your doorstep.

**Open for Inspection**

By Appointment.

Features Include:

- Two bedrooms with ceiling fans, one with built-in robes
- Central entertaining area, plantation shutters throughout
- Sunny kitchen with dishwasher and integrated washer/dryer
- Well-presented bathroom complete with a bath
- Double glazed windows, rear parking space on title
- Engineered oak floorboards throughout, high ceilings
- Sun-soaked NW orientation drawing in afternoon light
- Footsteps to Woolworths, shops and an array of eateries
- Buses to the CBD and Watsons Bay at your doorstep
- Walk through Lyne Park to ferry for a scenic trip to the city

Do not miss this Wonderful Opportunity!

Available: NOW!

### Listed By

The Office

Phone: (02) 9387 4911

The Office

Phone: (02) 9387 4911



Floorplan

**CENTURY 21.**  
Armstrong-Smith

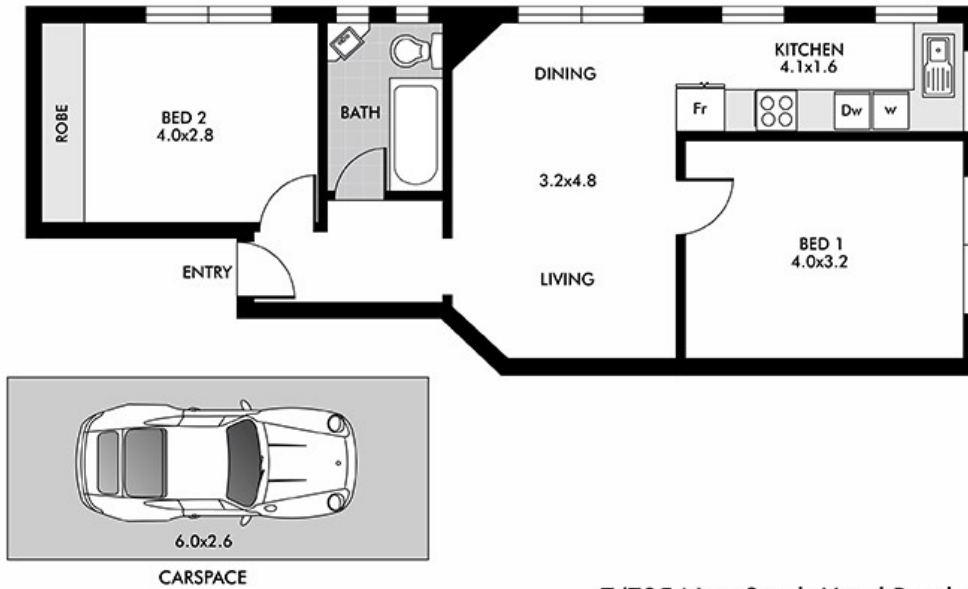

7/735 New South Head Road, Rose Bay

This diagram is for illustrative purposes only. All reasonable care has been taken in the preparation, but no warranty is given to the accuracy of the information. This document does not constitute any part of any offer or contract. Dimensions shown are approximate only. Prospective purchasers must rely on their own enquiries.

