

65 Mistful Park Rd, Goulburn, NSW 2580

Sold - 20/11/2025

House 4  2  4 



Modern Home : Ticks all the boxes!

Discover your dream family haven in this beautifully crafted four-bedroom, two-bathroom home that perfectly balances comfort with practicality. Spanning 253 square metres of thoughtfully designed living space, this quality-built residence showcases superior craftsmanship throughout every corner.

Open for Inspection

By Appointment.

The heart of the home features spacious living areas that flow seamlessly together, creating the perfect environment for family gatherings and entertaining. The generous primary bedroom offers a peaceful retreat, while three additional bedrooms provide flexibility for growing families, home offices, or guest accommodation.

Situated in Goulburn's sought-after Mistful Park estate, you'll enjoy the convenience of walking to the newly constructed shopping precinct featuring a supermarket, doctors surgery, car wash, day care centre, automotive services, and specialty retailers. It's like having your own village at your doorstep!

The property's substantial fully-fenced lot size provides ample space for outdoor activities and future improvements. Storage enthusiasts will appreciate the additional double garage at the rear, complete with power connection and concrete flooring.

Families will love the proximity to quality educational facilities including Mulwaree High School, while the nearby Riverside dog park offers perfect weekend adventures for four-legged family members. The location strikes an ideal balance between peaceful suburban living and urban conveniences.

This exceptional home represents outstanding value in one of Goulburn's most desirable growth areas, where quality construction meets community convenience in a neighbourhood that's rapidly becoming the place to be.

Listed By

Edwina Grant

Mobile: 0416 032 086



Floorplan

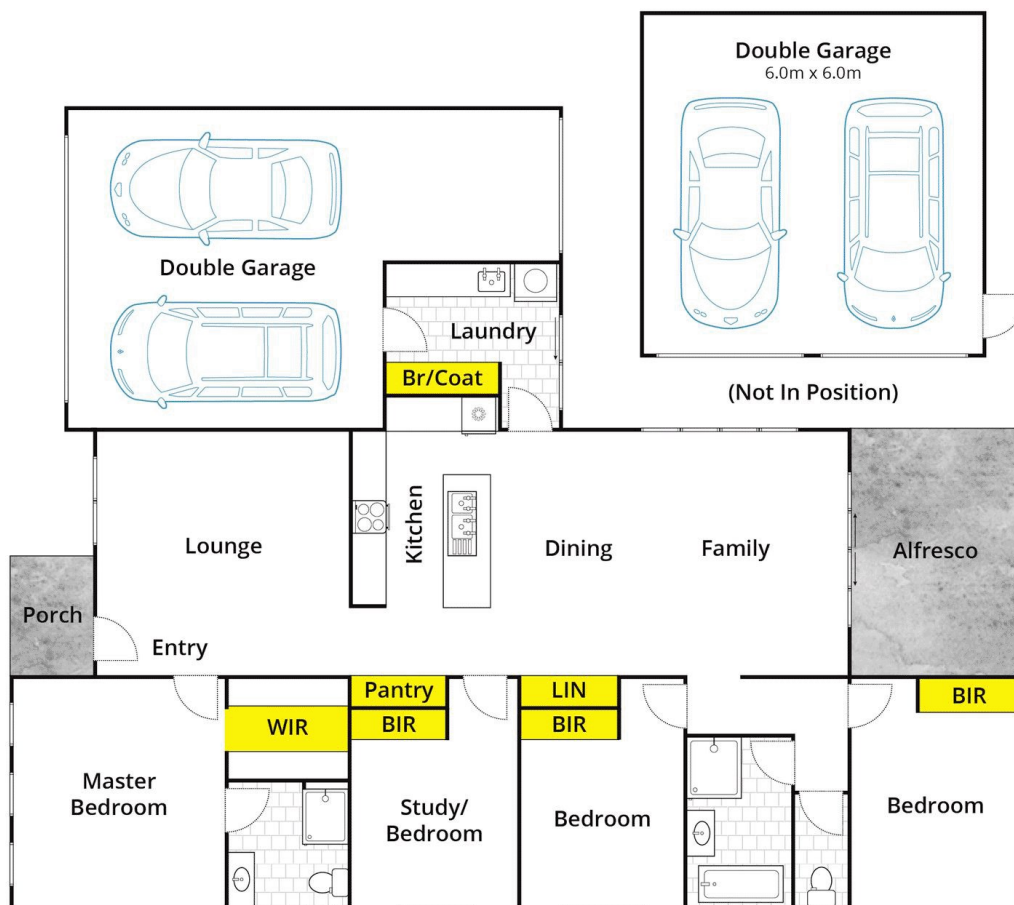

Approx. House Area 182m²

Whilst bwrn.com.au has made every attempt to ensure the accuracy of the floor plan contained here, measurements are approximate and no responsibility is taken for any error, omission, or mis-statement. This plan is for illustrative purposes only.

65 Mistful Park Road, Goulburn

