

6 Yackerboon Pl, Orange, NSW 2800

\$1,520,000

House 5 4 4



BEAUTIFUL HOME ON LARGE ELEVATED BLOCK WITH VIEWS!

With over 5,000sqm of land and a well-designed home with great views looking over the Ploughmans Wetlands, you will enjoy coming home. The current owners love their home, but with job opportunities interstate, someone else can now own this lovely home and property. As soon as you enter the light filled entry foyer with beautiful chandelier and wall paneling, you get the feeling that the rest of the home is just as inviting. Other features are, four or five bedrooms, three en-suites, large central living area plus a large north facing living/dining/kitchen area that is flooded with natural light, formal dining, and two of the bedrooms have a loft which the kids love.

OTHER USEFULL INFORMATION:

- Attached double garage with internal access, large carport, and shed/garage/workshop
- Covered outdoor alfresco area and landscaped gardens
- Town services connected plus large water tank
- Zoned Orange High School and Calare Public
- Walk to The Wentworth, Ploughmans Wetlands, and a short drive to Duntryleague

Open for Inspection

By Appointment.

Listed By



Chris Tyack
Phone: (02) 63621233
Mobile: 0438 258 590



Floorplan



6 Yackerboon Pl, Orange

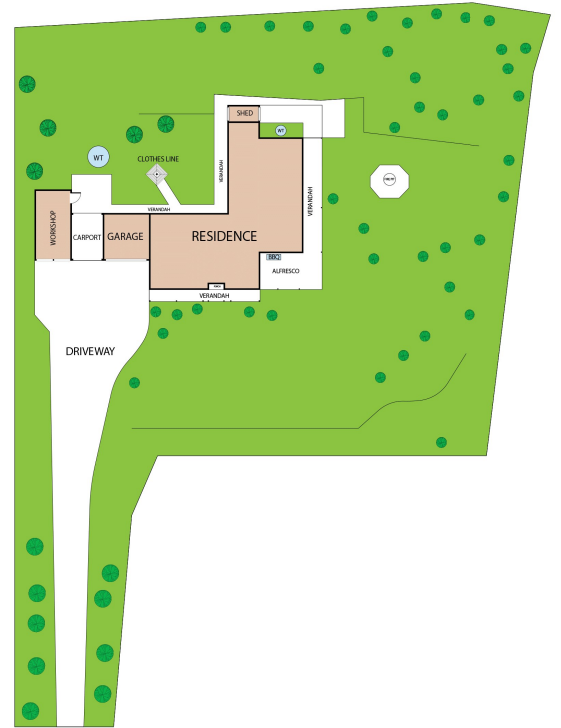

This plan is for layout guidance only. Not drawn to scale unless stated.
Windows and door openings are approximate. Whilst every care is taken in the preparation of this plan,
please check all dimensions, shapes and compass bearings before making any decisions reliant upon them.