

6 Alma Ct, St Helens, TAS 7216

\$649,000

House 4  2 



Near-new home with room for everyone

Set in a quiet street just walking distance from the centre of town, this near-new home is ready for its new owner (and their extended family) to move in and love. With the roomy home and a self-contained Granny-flat, this is the ideal home for a multi-generational living arrangement, or for someone wanting to earn some passive income.

Well positioned on the block, this attractive home boasts a huge loungeroom warmed by a centrally located wood heater. The three bedrooms all have built-in wardrobes, while the modern bathroom and second toilet offer the convenience everyone hopes for in a modern home. The solid hardwood flooring in the dining and kitchen areas offers a sense of tradition and glamour to the living space.

The self-contained bungalow lends itself to multi-generational living, visitor accommodation or an income stream. Both buildings are heavily insulated, making them cosy living spaces for the whole family.

The garden is ready for your personal touch, with some basic landscaping already established around the generous deck that opens off the dining area. The spacious back yard offers the ability for a shed or garage to be built to suit your needs (STCA).

St Helens is the largest centre on the East Coast and offers an enviable lifestyle for anyone who appreciates living within easy access to stunning natural beauty, fresh and saltwater fishing, surfing, diving, world-class mountain bike trails, bush walking and following exquisite food and wine trails. The town is fully serviced with schools, hospital, hardware, cafes and restaurants, community centre, light industrial area and employment opportunities.

Rates approximately \$1000/year

Zoned General Residential

Open for Inspection

By Appointment.

Listed By

Kate Spilsbury

Mobile: 0419 683 904



Floorplan



BUNGALOW

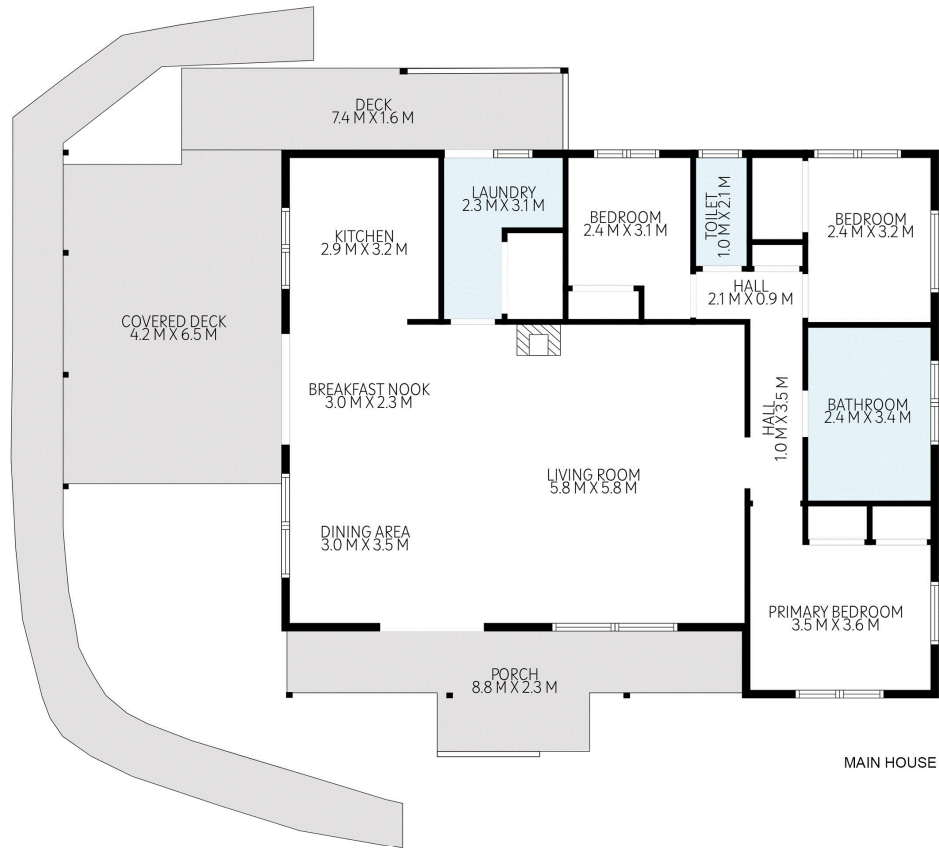

MAIN HOUSE



TOTAL: 137 m²

MAIN HOUSE: 117 m²

BUNGALOW: 20 m²

EXCLUDED AREAS: PATHWAY: 24 m², PORCH: 14 m²,

COVERED DECK: 27 m², DECK: 21 m², WALLS: 10 m²

FLOOR PLAN IS INDICATIVE OF THE LAYOUT. DIMENSIONS ARE HIGHLY RELIABLE NOT GUARANTEED

6 Alma Court, St Helens 7216

