

59 Iodide St, Broken Hill, NSW 2880

Contact Agent

Industrial Land



Rosella Distributors - 59 Iodide Street

For the first time in decades, this long standing family company is being offered to the market. With a proud history spanning many years and a strong repeat customer base, it presents both a thriving business and freehold property in one package!

Open for Inspection

By Appointment.

The premises is located on the corner of Iodide and Blende Street, the building itself includes a large warehouse, dedicated office space, loading dock and ample storage, providing the ideal foundation for ongoing success.

Inspections by appointment with selling agent only..

Land rates: approx \$3,662

Water rates: approx \$1,000

Disclaimer: All information contained therein is gathered from relevant third party sources. We cannot guarantee or give any warranty about the information provided. Interested parties must rely solely on their own enquiries. All distances and measurements are approximates only.

Listed By

Tara Nadge

Phone: (08) 8087 3666

Mobile: 0448 608 604



Floorplan

59 Iodide Street, Broken Hill

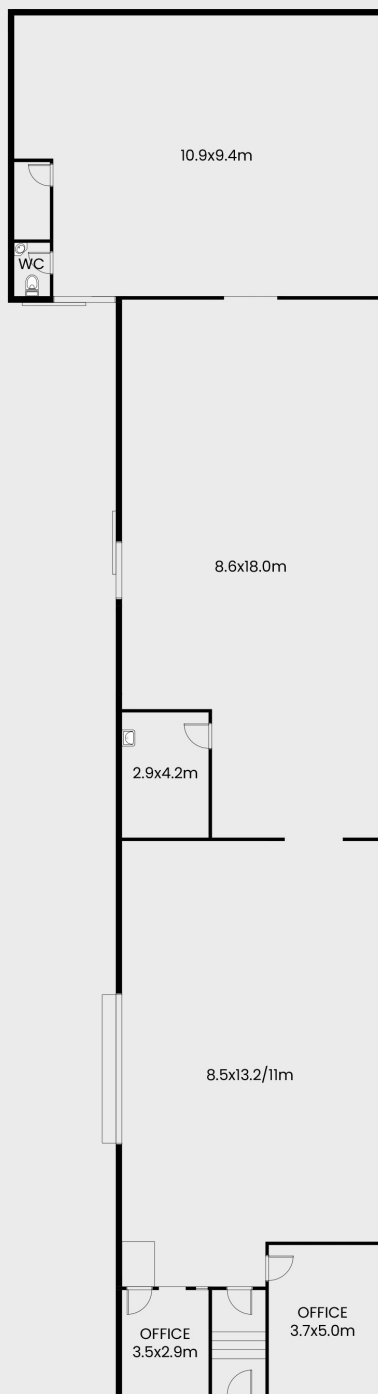

This floor plan including furniture, fixture measurements and dimensions are approximate and for illustrative purposes only. BoxBrownie.com gives no guarantee, warranty or representation as to the accuracy and layout. All enquiries must be directed to the agent, vendor or party representing this floor plan.