



5/28 Morris Ave, Croydon Park, NSW 2133

Sold - \$570,000

Apartment 2  1  1 



Sunny & Peacefull

Great opportunity for fresh start in this fantastic top floor sundrenched apartment set in Quiet Cul De Sac, Ideal for astute investors or those seeking a private yet convenient abode.
Watkins Real Estate is offering this property for sale by private treaty.

- North East aspect with only one adjoining wall
 - Hallway entry to open plan living area
 - Bright Kitchen enjoying sunny outlook
 - Well proportioned bedrooms with Built In Robes
 - Main bedroom features leafy outlook & balcony
 - Security Complex of only 8
 - Single car space at rear
 - Currently leased for \$430 per week until May 2024
 - Enquire Sham Watkins 0409 286 652
- Strata - \$2600 per annum
Water - \$661 p.a
Council - \$1447 p.a

Open for Inspection

By Appointment.

Property Features

- Top floor
- Quiet location
- North aspect

Listed By

Sham Watkins

Mobile: 0409 286 652



Floorplan

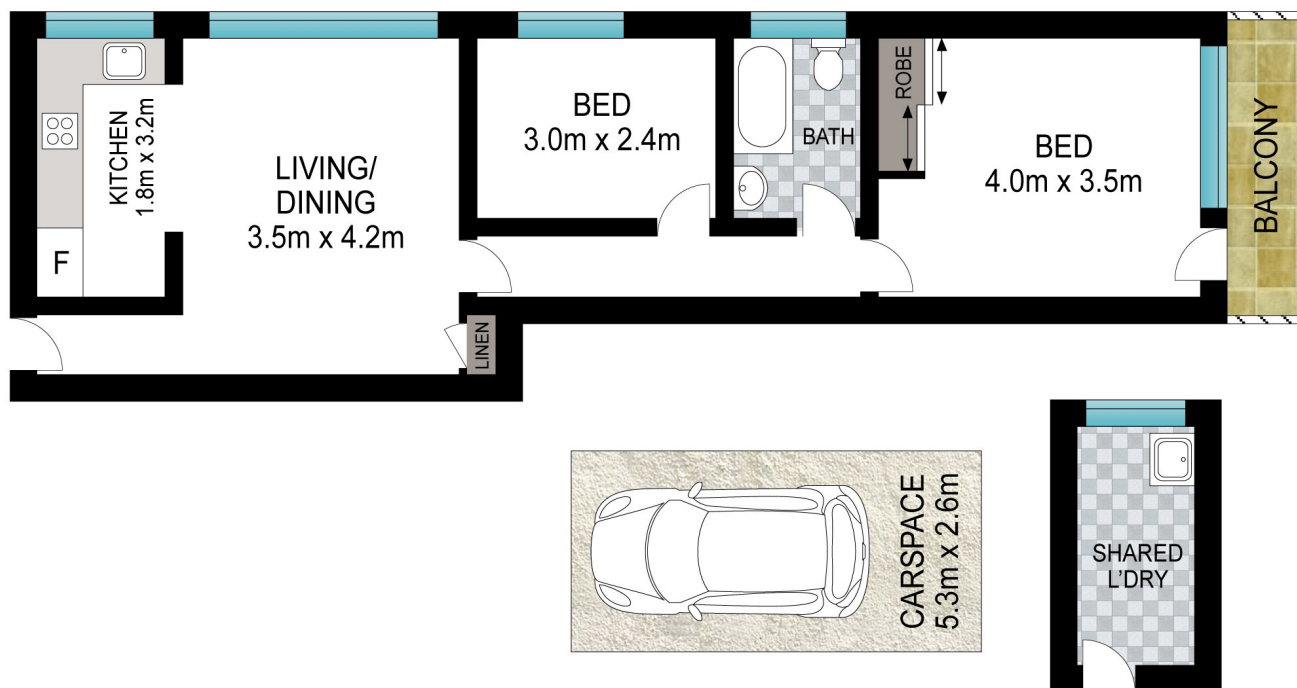

INT: 55 m²
EXT: 3 m²



Scale in metres. Indicative only. Dimensions are approximate. All information contained herein is gathered from sources we believe to be reliable. However, we cannot guarantee its accuracy and interested persons should rely on their own enquiries.

5/28 Morris Avenue, Croydon Park