



32 Silver Ash Way, Thornleigh, NSW 2120

Sold - 18/05/2013

Townhouse 3  2  2 



SOLD BY MARGARET MCGREGOR

Stylish and contemporary 3 bedroom + study townhouse which combines light filled interiors and large outdoor terrace giving approximately 93m² of indoor/outdoor living area, with total floor area of 173m². In a boutique complex with resort-style facilities including Clubhouse and luxury pool - enjoy the convenience of low maintenance living yet close to rail, schools, buses and shopping.

Open for Inspection

By Appointment.

- . 3 bedrooms (all with built in robes & the master with ensuite) + study
- . Spacious open plan living areas opening to alfresco deck
- . Stone finished gourmet gas kitchen with S/S appliances
- . Guest powder room, security system & ducted reverse cycle air
- . Gas hot water & gas for heating and pet friendly community
- . Landscaped low maintenance yard, internal access to garaging, storage
- . Ideal investment opportunity - rent return approx \$660 per week

Conveniently located just 1.1km to Thornleigh Station with a walk to primary school, shops and parks and on the local bus route to Hornsby Westfield and sought after schooling the area has to offer including Barker, Abbotsleigh, Knox, Loretto, Pennant Hills High, Normanhurst Boys & Hornsby Girls.

Listed By

Margaret McGregor
Phone: (02) 9875 5722
Mobile: 0417 257 253



Floorplan

32 Silver Ash Way, THORNLEIGH

Internal floor area approx: 173 sq/m

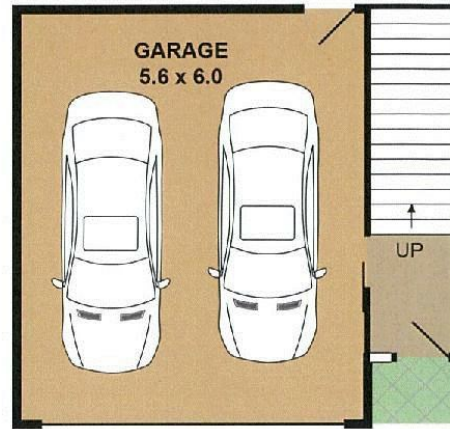

Lower Level

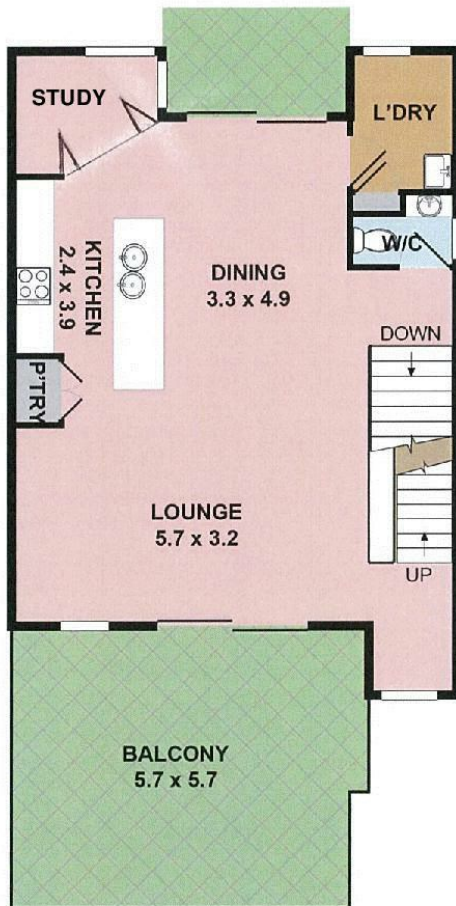

Middle Level

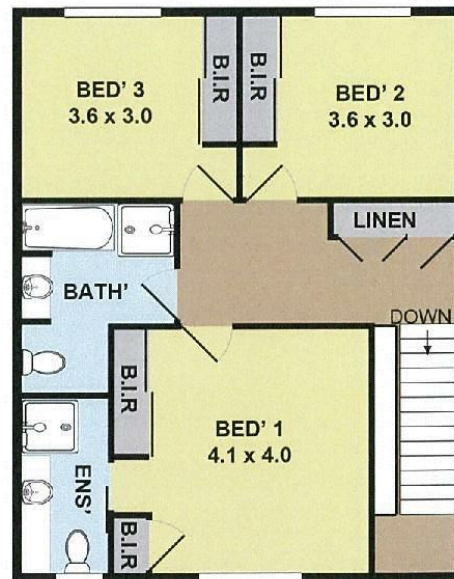

Top Level

Measurements are approximate and not to scale
Illustrative and promotional purposes only
Open 2 View does not accept responsibility for any information supplied

