

3/23 Durgadin Dr, Albion Park Rail, NSW 2527

Sold - 1/06/2017

Warehouse

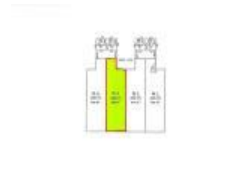
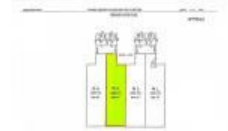

STRATA INDUSTRIAL UNIT

- * Hard to find strata unit
- * Small complex of 4 units
- * Total unit ground floor 375sqm plus mezzanine at 68sqm
- * High clearance roller door access
- * Modern designs, Central at Albion Park Rail Industrial Park
- * Current month to month tenancy
- * Out Goings - Council Rates - \$2,420, Water Rates - \$1,024, Strata - \$3,806

Open for Inspection

By Appointment.

Listed By

Harry Stefanou
Phone: (02) 4229 6640
Mobile: 0413 737 585

