

**270 Peats Ferry Rd, Hornsby, NSW 2077**

**Sold - 15/06/2025**

Retail Shop, Medical/Consulting, Office Suite



**SOLD**

Prime sought after freestanding retail shop is located in a prominent position on Peats Ferry Road (Formerly Pacific Highway). Ex Real Estate Agency office, owner retired.

Located within the heart of the vibrant rezoned Hornsby Westside CBD precinct and Zoned B4 Mixed Use - high rise, with an allowable height of 77.5 Metres mixed use commercial/residential FSR of 3:1

Tightly held this property has excellent opportunity for future development this opportunity is rarely available.

Currently there is a substantial approx 150 sqm shop, with front and rear access, kitchenette, toilet facilities, and air-conditioning.

Front and rear access  
Kitchenette  
Toilet facilities  
Air conditioning

Permitted uses subject to council approval;  
Boarding houses; Centre-based childcare facilities; Commercial premises; Community facilities; Educational establishments; Entertainment facilities; Function centres; Hostels; Hotel or motel accommodation; Information and education facilities; Light industries; Medical centres; Oyster aquaculture; Passenger transport facilities; Recreation facilities (indoor); Registered clubs; Respite day care centres; Restricted premises; Roads; Seniors housing; Shop top housing;

Premier location being approximately 150 metres to Hornsby railway station, and within metres to Hornsby police station, Hornsby court house, Hornsby council, Hornsby pool, and Hornsby Tafe

**Listed By**

Sam Mamari  
Phone: (02) 9987 0055  
Mobile: 0410 477 269

**Open for Inspection**

By Appointment.

**Property Features**

- Hornsby Westside CBD precinct
- Zoned B4 Mixed Use - high rise
- allowable height of 77.5 Metres mixed use
- Approx 151 SQM shop
- commercial/residential



## Floorplan

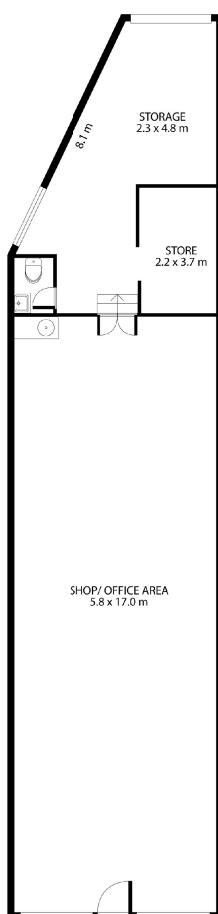

## 270 Peats Ferry Rd, Hornsby

Disclaimer: Floor Plans and site plans are intended as a guide only. They are not part of any legal document or title and are subject to inaccuracy and should not be used as legal reference. Sizes are approximate only.

