



26/77 Belmont St, Sutherland, NSW 2232

Sold - \$1,020,000

Townhouse 2  1  2 



Growing Family ?

Set at the entrance to "Lillydale" this dual living area two bedroom townhouse is ready for you to unpack & relax. Offering two separate living areas & enclosable courtyard suitable for growing family or those seeking versatile lifestyle, ideally located within short stroll to vast array of sports & town centre.

- Two generous bedrooms with Built in Robes
- Master bedroom features private outdoor terrace
- Enclosable freshly oiled outdoor deck area
- Access to street from courtyard gate
- Open plan kitchen & dining area
- Ducted range hood exhaust
- Large functional laundry with storage
- Timber & Tiled floors to living areas
- Possible 3rd bedroom configuration
- Two split system air conditioners
- Natural Gas cooktop, h/w, heating & Bbq outlets
- DOUBLE car space & two storage areas
- Strata - \$1042 per ¼
- Water - \$180 per ¼
- Council - \$400 per ¼

We invite you to experience this truly unique Tuscan themed entrance area & versatile courtyard

Open for Inspection

By Appointment.

Property Features

- Two living areas
- Set at entrance to complex
- Double car space

Listed By
Sham Watkins

Mobile: 0409 286 652



Floorplan

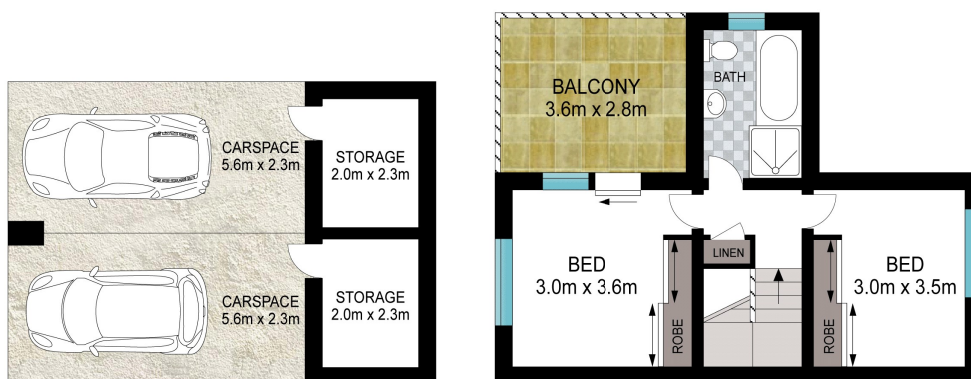

FIRST FLOOR

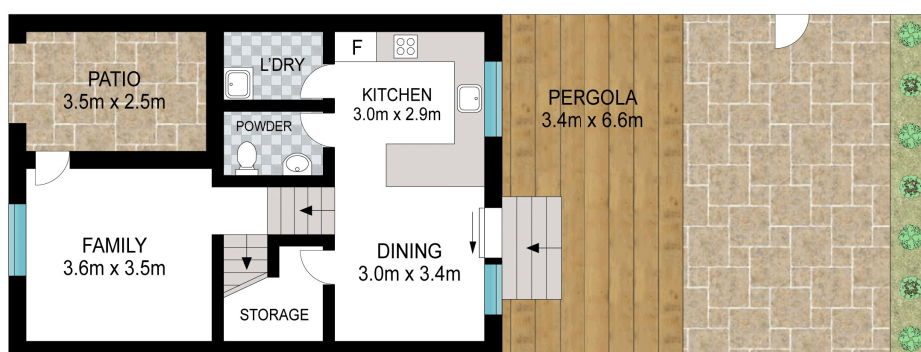

GROUND FLOOR



Scale in metres. Indicative only. Dimensions are approximate. All information contained herein is gathered from sources we believe to be reliable. However, we cannot guarantee its accuracy and interested persons should rely on their own enquiries.



26/77 Belmont Street, Sutherland