

2/68-70 Peisley St, Orange, NSW 2800

Leased - \$1307 per Year

Office Suite 9 

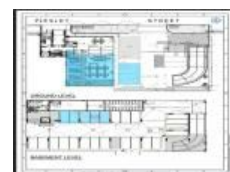

## ATTRACTIVE EXECUTIVE OFFICE SUITE

A modern ground floor light filled office suite located close to the CBD on the main thoroughfare to the Hospitals, Airport and the Cadia gold mine.

The total floor area is 159.6 m2 and features 3 private offices, a spacious open plan main working area and a kitchen with staff meals room.

4 above ground parking spaces and 5 secure basement parking spaces included.

**Open for Inspection**

By Appointment.

### Listed By

Chris Gryllis  
Phone: (02) 6362 5999  
Mobile: 0417 626 361

