

2/26 Early St, Parramatta, NSW 2150

Sold - \$550,000

Unit 2  1  1 



Welcome to Your Spacious Sanctuary with Two Balconies!

Nestled on the first floor of a secure block, this charming 2-bedroom unit beckons with its generous proportions and thoughtful layout, boasting delightful East and West-facing aspects to soak in the sunshine. Situated on the cusp of Parramatta CBD, mere moments from Westfield Shopping Centre, transport hubs, and an array of amenities, reputable schools, vibrant city night life, trendy restaurants, cafes, this is the epitome of convenient living.

Key Features:

- * Building area approximately 109m²
- * Defined Open Plan Lounge & Dining Area
- * Separate Kitchen with Modern Appliances
- * Fully Tiled Bathroom with Bathtub & Ventilation Window
- * Two Undercover Balconies
- * Built-in Robes to Both Bedrooms
- * Reverse-cycle Air Conditioning
- * Solid Brick Construction & Floating Floorboards Throughout
- * Internal Laundry & Lock-up Garage

Strata levy: Approx \$715/Q

Council rates: Approx \$303/Q

Water rates: Approx: \$165/Q

Don't miss this opportunity to make this unit your own slice of paradise, where modern comfort meets unbeatable convenience. Contact us today to arrange an inspection and secure your future in this sought-after location!

Open for Inspection

By Appointment.

Listed By

Adam Chang

Phone: (02) 9633 9955

Mobile: 0417 818 018



Floorplan

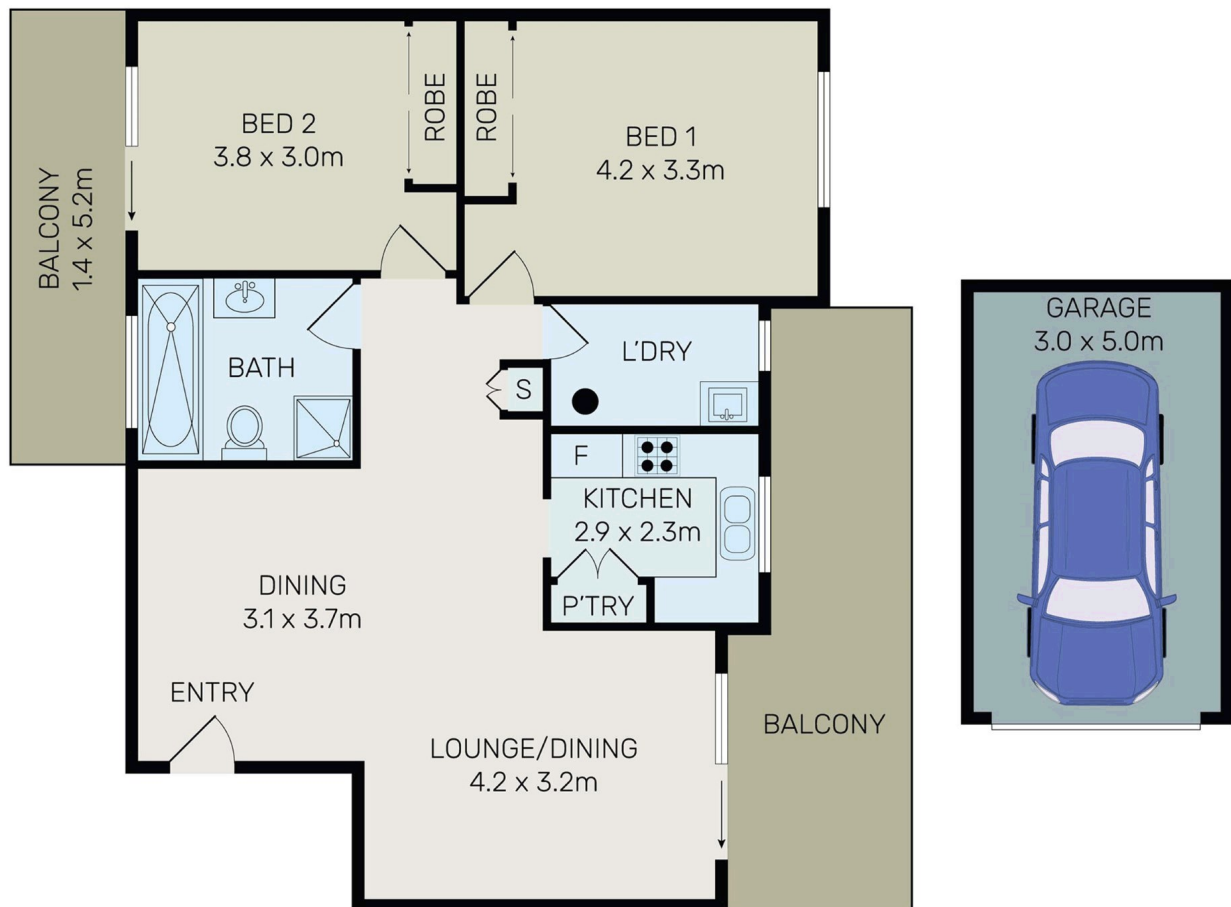

All information contained herein is gathered from all sources we believe to be reliable. However we cannot guarantee its accuracy and interested parties should rely on their own enquiries.



2/26 Early Street, Parramatta