

2/23 High St, Wodonga, VIC 3690

Leased - \$16,800

Warehouse

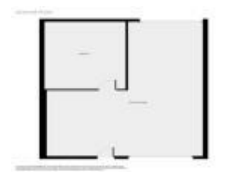

PRIME LOCATION WORKSHOP SPACE!

Main High Street frontage, situated in central Wodonga.

This 105m2 (approx.) workshop & office area has dual access with manual high range roller doors, separate office & a separate toilet.

Please call our office on 02 6024 9222 to arrange your inspection today.

Open for Inspection

By Appointment.

Listed By

Natalee Willson

