

**14 Broken Shaft Cl, Orange, NSW 2800**

**Sold - 6/03/2020**

Acreage 6  3  4 



**TWO DWELLINGS ON A PEACEFUL 10.1HA (24.9 acres)**

Now here is a property that should get your interest! Just off the Ophir Road and a short drive to Orange is "Eucalypt Ridge" with the main dwelling approximately 362sqm under roof, the home has also been used for the owner's hobby work and has many living areas as well as 4 bedrooms and en-suite. The owners built another 2 bedroom cottage on the property complete with kitchen and bathroom for the hobby work and this makes it a great property for someone looking for extra accommodation for a family member or maybe an air BNB (subject to council approval). There are sheds and good water storage on the property as well as a dam and bore.

**Open for Inspection**

By Appointment.

**Property Features**

- Short drive to Orange
- Two separate dwellings
- Sealed road to driveway
- Peaceful location with wildlife

**Listed By**



Chris Tyack  
Phone: (02) 63621233  
Mobile: 0438 258 590



Floorplan



# 14 BROKEN SHAFT CL, ORANGE

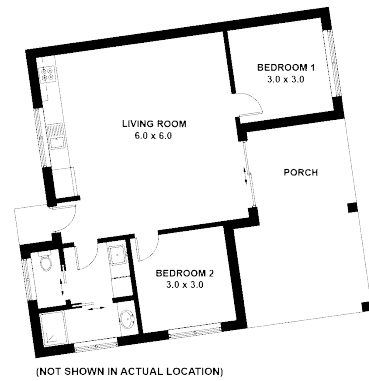

This plan is for layout guidance only. Not drawn to scale unless stated. Windows and door openings are approximate. Whilst every care is taken in the preparation of this plan, please check all dimensions, shapes and compass bearings before making any decisions reliant upon them.