

11 Horsley Dr, Horsley, NSW 2530

Sold - 5/06/2013

House 3  1  2 



Must Have Horsley

Great starting off property with 3 bedrooms, 1 bathroom and a spacious family and entertaining room. This home is great for families looking for their first home, with proximity to Dapto public school an added convenience. Enjoy nice afternoons under the covered outdoor entertaining area with family and friends while soaking up the established gardens previous owners have cultivated. This property also offers a garden shed to boot with a remote garage and plenty of space for any hobby to grow in. Close to Horsley shopping centre, experience all your needs within an easy walk.

Open for Inspection

By Appointment.

Listed By
Jeremy Tillman



Floorplan

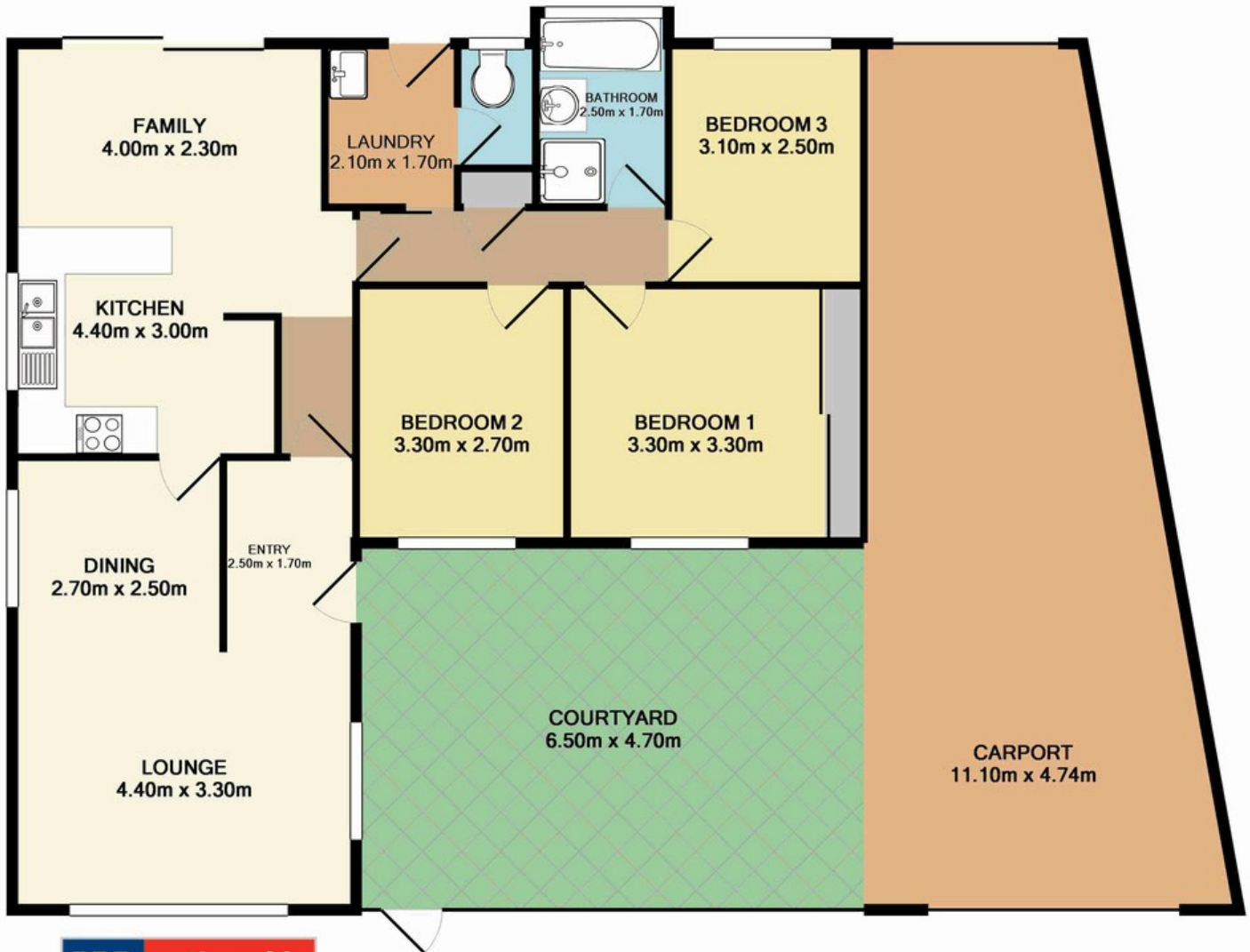

11 HORSLEY DRIVE, HORSLEY
Measurements are approximate. Not to Scale. For illustrative purposes only.