

103 Teralba Rd, Adamstown, NSW 2289

Sold - 29/03/2010

House 4 2

PLAN SHOWN ONLY INDICATIVE OF LAYOUT. DIMENSIONS ARE APPROXIMATE.

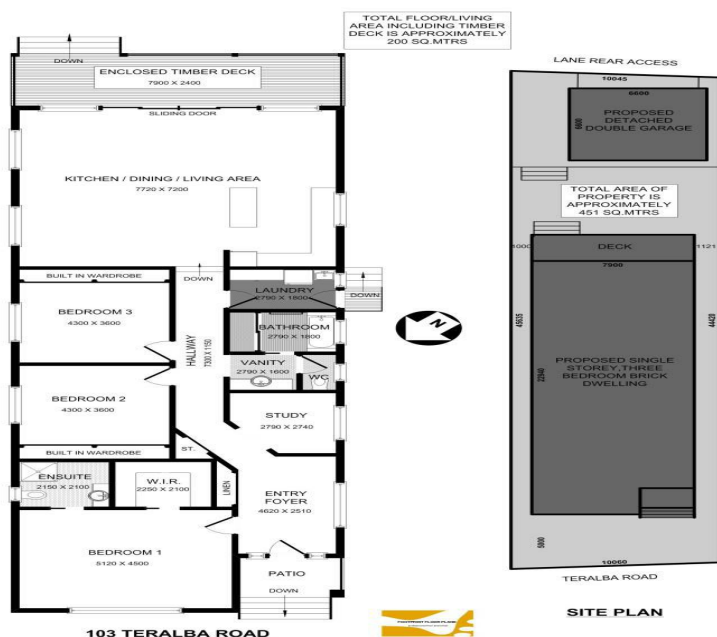

Brand New Home

Designed and built by Shelswel Homes

Single storey weatherboard clad and colorbond roof house

Weatherboards Dulux warm neutral/pearl white windows

Colorbond roof in dune with dune gutter and white fascia

Front entry door Hume XVP 12 part glass frosted antique

9" ceilings with 3 step fancy cornice

4 bed or 3 bed plus study

All internal doors factory fitted pre hung in Caprice panel design

Architraves and skirtings in f/j radiata pine pencil round 70 x 18m

Internal walls painted Dulux 'Natural White'

Woodwork in enamel

3 way bathroom plus ensuite, fully tiled with pivot doors to showers

Floors 300 x 300 Silkstone grey honed 30112

Walls 300 x 300 Silkstone white polished

Double garage with remote doors to rear access

Easy care landscaped grounds

Polished hardwood floors with carpets to bedrooms

Vacuum pressed kitchen with pantry and microwave tower and high gloss countertop and island bench

Stainless steel appliances/gas cook top and electric oven with canopy

Gas rinnai instantaneous Hot Water System

Vanities with moulded tops

Dorf taps or similar to all wet areas in chrome finish

3000 litre water tank installed

All external walls insulated and ceiling insulated with 3.0 Batts

Anticon blanket under colorbond roof for additional insulation

Ducted air conditioning and mirrored doors to robes

Listed By

Gerry Edser

Phone: (02) 4952 5588

Mobile: 0412 008 888

Open for Inspection

By Appointment.

