



10/43 Denham St, Bondi, NSW 2026

Leased - \$1,495

Apartment 2  1  1 



## Impeccably Renovated Coastal Apartment in the Heart of Bondi

Century 21 Armstrong-Smith - Bondi Junction are proud to present this newly renovated apartment showcasing refined interiors and a timeless coastal aesthetic bathed in natural light, it offers generous proportions and effortless indoor-outdoor living. Set within a secure boutique building, it delivers privacy, comfort and quality throughout. and is perfectly positioned moments from Bondi's cafés, transport and iconic beaches.

**Open for Inspection**

By Appointment.

Features Include:

- \* Impeccably renovated with premium finishes
- \* Light-filled open-plan living and dining area with wooden floors
- \* Designer kitchen with quality appliances including dishwasher
- \* Spacious bedrooms with excellent natural light and built in wardrobes
- \* Sleek contemporary bathroom with high-end fittings
- \* Private balcony for relaxed outdoor living
- \* Internal laundry for added convenience
- \* Secure lock-up garage
- \* Quiet, well-maintained security building
- \* Stroll to cafés, shops, transport and Bondi Beach

Available Now

Do not miss this wonderful opportunity

Disclaimer:

All images used in this advertisement are for illustrative and marketing purposes only. Furniture and decorations shown in the photos have been digitally staged and may not represent the actual Condition of the property. The property is rented unfurnished unless otherwise stated. Prospective tenants should conduct a physical inspection to verify the layout, condition, and features of the property.

**Listed By**

The Office

Phone: (02) 9387 4911



Floorplan

# 10/43 Denham Street BONDI

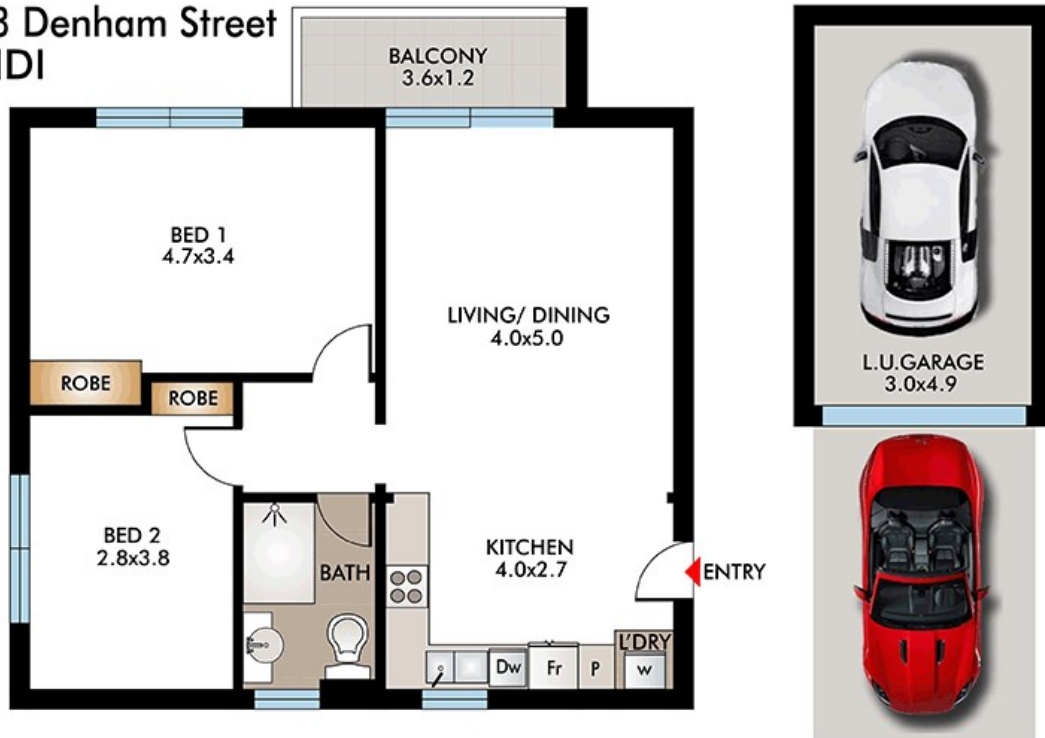

This diagram is for illustrative purpose only. All reasonable care has been taken in the preparation, but no warranty is given to the accuracy of the information. This document does not constitute any part of any offer or contract. Dimensions shown are approximate only. Prospective purchasers must rely on their own enquiries.

