



1,2,3/4 Amelia Ct, Kilsyth, VIC 3137

\$800,000 - \$880,000

Townhouse 3  2  2 



## The Choice is Yours!

Perched on the high side of a quiet court location and with panoramic northerly aspect, each of these brand new townhouses, built to a 7 star rating, are ready to move in for 2026.

Each property features a generous double garage while offering 3 bedrooms, single or double storey, single or dual living zones, family bathroom and en-suite to main bedroom.

Comfort is ensured by total temperature control throughout with Rinnai central heating and cooling while the all electric modern appliances ensure convenience. Enjoy the balanced natural light throughout each property.

Close proximity to Churinga shopping centre, public transport, medical specialists and schools make these a phenomenal choice.

Unit 1: \$890,000-\$955,000

Unit 2: \$800,000-\$880,000

Unit 3: \$850,000-\$920,000

Call to Inspect

### Open for Inspection

Sat, 20 Dec 2025 - 11:00 AM to 11:30 AM

### Listed By

Richard Goldsmith  
Phone: (03) 9726 7711  
Mobile: 0407 348 172

Ben Hudson



## Floorplan

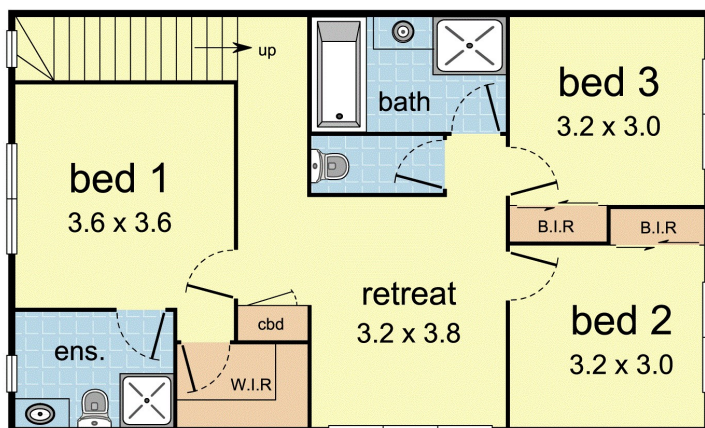
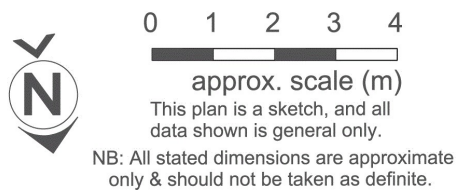

first floor

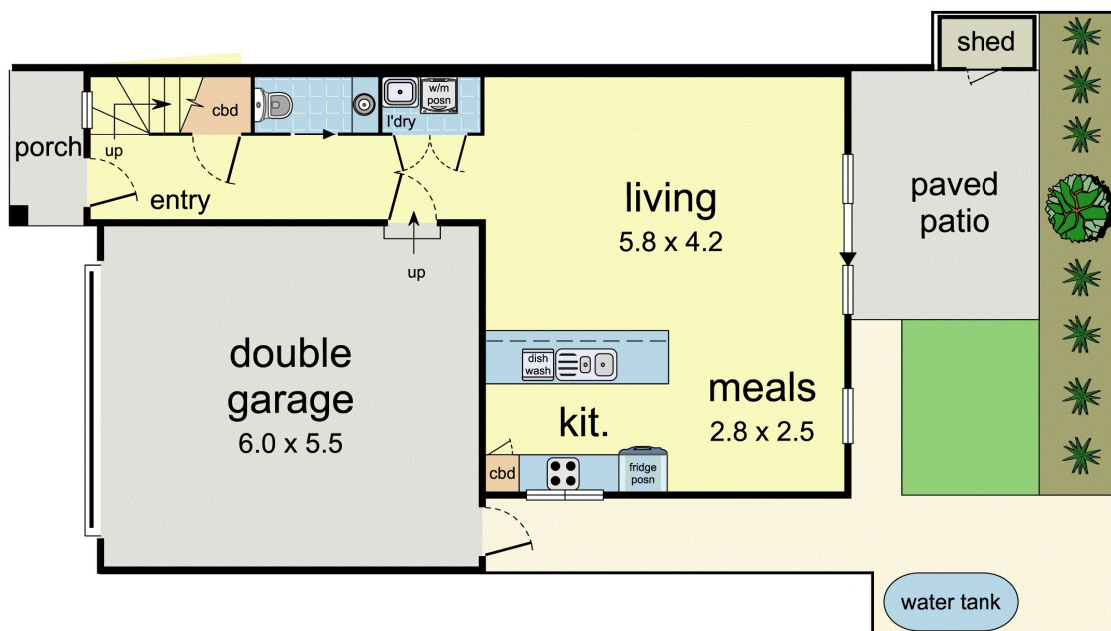

## Unit 2, 4 Amelia Court, Kilsyth